



Summary

[Request a quote](#)

[Catalog](#)

Number of contacts High Voltage	1
Wire Size/AWG	18 - 10
Socket / Receptacle	Socket / Receptacle - Fixed Panel Front Mounted
Locking system	Push-pull
Jacket cable outside diameter [mm]	4.30 - 5.70 mm
Size	3S
Series	S - Indoor Stepped Insert

Technical details

Electrical Configuration

Contact Termination High voltage	Solder
Insert configuration value	3S.405 - 1 High Voltage
Insulator	T: PTFE
Rated current	15 Amps
Test voltage (kV AC)	7.5
Contact Type	Solder
Air clearance	12.8 mm
Creepage distance	12.9 mm
Contact Dia.	4
Number of contacts High Voltage	1
Wire Size/AWG	18 - 10

https://www.lemo.com/int_en/solutions/originals/s-indoor-stepped-insert/psa-3s-405-ctlc52.html

LEMO products and services are provided "as is". LEMO makes no warranties or representations with regard to LEMO product & services or use of them, express, implied or statutory, including for accuracy, completeness, or security. The user is fully responsible for his products and applications using LEMO components.

Form & Material

Shell style / Model id	PSA - Fixed receptacle, nut fixing, cable collet
Socket / Receptacle	Fixed Panel Front Mounted
Housing material	Brass (chrome plated [SAE AMS 2460]) shell and collet nut, nickel plated [SAE AMS QQ N 290] brass latch sleeve and mid pieces
Locking system	Push-pull
Keying	Circular, female
Weight	57 g

Cable fixation

Cable termination protection	Standard back nut (no additional protection)
Fixation type	Cable collet
Jacket cable outside diameter [mm]	4.30 - 5.70 mm

Drawings

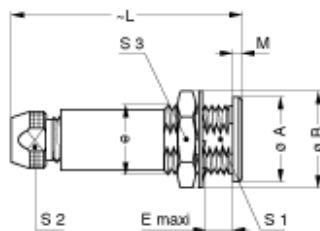

Dimensions

	A	B	e	E	L	M	S1	S2	S3
mm.	22	25.2	M18x1.0	11.5	59	2	16.5	14	22
in.	0.87	0.99		0.45	2.32	0.08	0.65	0.55	0.87

https://www.lemo.com/int_en/solutions/originals/s-indoor-stepped-insert/psa-3s-405-ctlc52.html

LEMO products and services are provided "as is". LEMO makes no warranties or representations with regard to LEMO product & services or use of them, express, implied or statutory, including for accuracy, completeness, or security. The user is fully responsible for his products and applications using LEMO components.