



Image for illustrative purpose only

Summary

[Request a quote](#)

[Catalog](#)

Nb of contacts Coax	1
Socket / Receptacle	Socket / Receptacle - Fixed Panel Front Mounted
Locking system	Push-pull
Jacket cable outside diameter [mm]	4.60 - 5.00 mm
Size	1E
Suggested matching part	FFA.1E.250.CTAC50Z
Series	E - Outdoor Stepped Insert

https://www.lemo.com/int_en/solutions/originals/e-outdoor-stepped-insert/psa-1e-250-ctlc50z.html

LEMO products and services are provided "as is". LEMO makes no warranties or representations with regard to LEMO product & services or use of them, express, implied or statutory, including for accuracy, completeness, or security. The user is fully responsible for his products and applications using LEMO components.

Technical details

Electrical Configuration

Nb of contacts Coax	1
Contact Termination Coax - Conductor fixing	Solder
Insert configuration value	1E.250 - 1 Coax (50 Ohm)
Insulator	T: PTFE
Rated current	12 A
Impedance	50 Ohm
OHM	50
VSWR	$1.01 + 0.23 * f/\text{GHz}$
Vtest	3000 V (AC), 4200 V (DC)
Cable type	RG 178 B/U, RG 196 A/U, RG 188 A/U, RG 316 B/U, RG 174 A/U, HF-2114, RG 122 /U
Bucket Dia.	1 mm (0.039in)
Contact Dia.	0.9 mm (0.035in)

Form & Material

Shell style / Model id	PSA - Fixed receptacle, nut fixing, cable collet
Socket / Receptacle	Fixed Panel Front Mounted
Housing material	Brass (chrome plated [SAE AMS 2460]) shell, collet nut and latch sleeve, nickel plated [SAE AMS QQ N 290] brass mid pieces
Locking system	Push-pull
Keying	Circular, female
Colour	Grey
Variant	Nut for fitting a bend relief
Weight	35.32 g

https://www.lemo.com/int_en/solutions/originals/e-outdoor-stepped-insert/psa-1e-250-ctlc50z.html

LEMO products and services are provided "as is". LEMO makes no warranties or representations with regard to LEMO product & services or use of them, express, implied or statutory, including for accuracy, completeness, or security. The user is fully responsible for his products and applications using LEMO components.

Environment

Technical domain	Energy and Industrial, Test and Measurement
Environmental sealing (IP rating)	IP68
Endurance	5000 mating cycles
Temperature range	-55°C / +200°C (max. temperature valid for short periods of use.)
Climatical Category	50/175/21
Humidity (max)	<=95% [at 60 deg C /140 F]
Shielding (min)	95 dB (10 MHz)
Shielding (min)	80 dB (1 GHz)
Shock Resistance	100 g [6 ms]
Vibration	15 g [10 Hz - 2000 Hz]
Salt Spray Corrosion	>1000 hr

Cable fixation

Cable termination protection	For cable bend relief
Fixation type	Cable collet
Jacket cable outside diameter [mm]	4.60 - 5.00 mm

Drawings

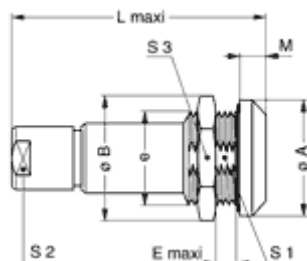

Dimensions

	A	B	e	E	L	M	S1	S2	S3
mm.	20	21.5	M16x1.0	9	45	4.5	14.5	9	19
in.	0.79	0.85		0.35	1.77	0.18	0.57	0.35	0.75

https://www.lemo.com/int_en/solutions/originals/e-outdoor-stepped-insert/psa-1e-250-ctlc50z.html

LEMO products and services are provided "as is". LEMO makes no warranties or representations with regard to LEMO product & services or use of them, express, implied or statutory, including for accuracy, completeness, or security. The user is fully responsible for his products and applications using LEMO components.



Recommended By Lemo

Accessories

Compatible cap

[BRE.1K.200.NAS](#)

Cables

Cable PartNumber	Material	Colour	Cable image
158480	PUR	Black	
158490	PVC	Black	
CCX.50.088.292495N	PVC	Black	
CCX.50.RG5.8CU50N	PVC	Black	

https://www.lemo.com/int_en/solutions/originals/e-outdoor-stepped-insert/psa-1e-250-ctlc50z.html

LEMO products and services are provided "as is". LEMO makes no warranties or representations with regard to LEMO product & services or use of them, express, implied or statutory, including for accuracy, completeness, or security. The user is fully responsible for his products and applications using LEMO components.