

## Summary

[Request a quote](#)

[Catalog](#)

Low Voltage	6
Gender	Standard
Socket / Receptacle	Socket / Receptacle - Elbow
Locking system	Push-pull
Size	1P
Series	REDEL P - Push-Pull

## Technical details

### Electrical Configuration

Contact Termination Low voltage	PCB - Straight
R (max)	6.5 mOhm
Insert configuration value	1P.M06 - 6 Low Voltage
Insulator	G: PSU gray
Rated current	6 Amps
Test voltage (kV rms) Contact-contact	1.05
Contact Type	Print (straight)
Air clearance	0.85 mm
Creepage distance	0.85 mm
Contact Dia.	0.7 mm (0.0275in)
Low Voltage	6
Gender	Standard

[https://www.lemo.com/int\\_en/solutions/redel/redel-p-push-pull/ppg-m0-6ng-n.html](https://www.lemo.com/int_en/solutions/redel/redel-p-push-pull/ppg-m0-6ng-n.html)

LEMO products and services are provided "as is". LEMO makes no warranties or representations with regard to LEMO product & services or use of them, express, implied or statutory, including for accuracy, completeness, or security. The user is fully responsible for his products and applications using LEMO components.

## Form & Material

Shell style / Model id	PP - Elbow receptacle key (G) or keys (A,B,C) for printed circuit
Socket / Receptacle	Elbow
Housing material	PSU (Polysulfone), black
Locking system	Push-pull
Keying	1 key (alpha=0, Plug: male contact, Receptacle: female contact)
Weight	5.7 g

## Environment

Technical domain	Energy and Industrial, Medical, Test and Measurement, Transportation, Aerospace and UAV
Environmental protection (IP rating)	IP50
Minimal temperature	-50°C / +150°C
F ret (max)	150 N
F ret (min)	50 N
Steam sterilization	> 100 times (with potting on rear connection)

## Cable fixation

Cable termination protection	Standard back nut (no additional protection)
Fixation type	Cable collet

## Drawings

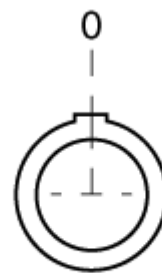

## Dimensions

	A	B	L	M	H
mm.	13.4	15.9	30.2	14.8	17.5
in.	0.53	0.63	1.19	0.58	0.69

[https://www.lemo.com/int\\_en/solutions/redel/redel-p-push-pull/ppg-m0-6ng-n.html](https://www.lemo.com/int_en/solutions/redel/redel-p-push-pull/ppg-m0-6ng-n.html)

LEMO products and services are provided "as is". LEMO makes no warranties or representations with regard to LEMO product & services or use of them, express, implied or statutory, including for accuracy, completeness, or security. The user is fully responsible for his products and applications using LEMO components.