



## Summary

[Request a quote](#)

[Catalog](#)

[See video assembly instructions](#)

Number of contacts Low Voltage	8
Wire Size/AWG	24 - 20
Gender	Standard
Plug	Plug - Straight
Locking system	Ratchet
Jacket cable outside diameter [mm]	6.50 - 13.00 mm
Size	2M
Matching parts	<a href="#">PMP.2M.308.XLMT</a>
Series	M - Rugged Ratchet coupling

## Technical details

[https://www.lemo.com/int\\_en/solutions/optima/m-ratchet-coupling/fmp-2m-308-xlct.html](https://www.lemo.com/int_en/solutions/optima/m-ratchet-coupling/fmp-2m-308-xlct.html)

LEMO products and services are provided "as is". LEMO makes no warranties or representations with regard to LEMO product & services or use of them, express, implied or statutory, including for accuracy, completeness, or security. The user is fully responsible for his products and applications using LEMO components.

## Electrical Configuration

Contact Termination Low voltage	Crimp
R (max)	4.8 mOhm
Insert configuration value	2M.308 - 8 Low Voltage
Insulator	L: PEEK
Rated current	10 Amps
Test voltage (kV rms) Contact-contact	1.95
Test voltage (kV rms) Contact-shell	1.1
Contact retention	30 N
Contact Type	Crimp
Max. Conductor	0.5 mm <sup>2</sup> (AWG 20)
Min. Conductor	0.25 mm <sup>2</sup> (AWG 24)
Bucket Dia.	1.1 mm (0.043in)
Contact Dia.	0.9 mm (0.035in)
Number of contacts Low Voltage	8
Wire Size/AWG	24 - 20
Gender	Standard

## Form & Material

Shell style / Model id	FM - Straight plug, key (N) or keys (P, R, S, T, U, V, W and X) with knurled grip and mold stop
Plug	Straight
Housing material	Aluminium (nickel plated [SAE AMS QQ N 290], anthracite color) shell and nut, other pieces bronze/brass
Locking system	Ratchet
Keying	3 keys (beta=150, gamma=60, plug: male contacts, receptacle: female contacts)
Weight	9.51 g

## Cable fixation

Cable termination protection	For overmolding
Fixation type	T type cable adapter
Jacket cable outside diameter [mm]	6.50 - 13.00 mm

[https://www.lemo.com/int\\_en/solutions/optima/m-ratchet-coupling/fmp-2m-308-xlct.html](https://www.lemo.com/int_en/solutions/optima/m-ratchet-coupling/fmp-2m-308-xlct.html)

LEMO products and services are provided "as is". LEMO makes no warranties or representations with regard to LEMO product & services or use of them, express, implied or statutory, including for accuracy, completeness, or security. The user is fully responsible for his products and applications using LEMO components.

# Drawings

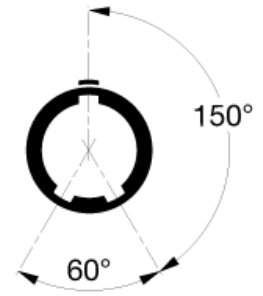
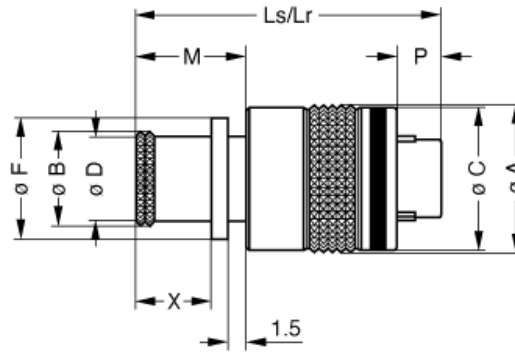

## Dimensions

	<b>A</b>	<b>B</b>	<b>C</b>	<b>D</b>	<b>F</b>	<b>Ls</b>	<b>Lr</b>	<b>M</b>	<b>P</b>	<b>X</b>
mm.	17.6	14	17.2	13	15.5	27.5	27.5	10.1	3.9	7.1
in.	0.69	0.55	0.68	0.51	0.61	1.08	1.08	0.4	0.15	0.28

[https://www.lemo.com/int\\_en/solutions/optima/m-ratchet-coupling/fmp-2m-308-xlct.html](https://www.lemo.com/int_en/solutions/optima/m-ratchet-coupling/fmp-2m-308-xlct.html)

LEMO products and services are provided "as is". LEMO makes no warranties or representations with regard to LEMO product & services or use of them, express, implied or statutory, including for accuracy, completeness, or security. The user is fully responsible for his products and applications using LEMO components.