



Summary

[Request a quote](#)

[Catalog](#)

[See video assembly instructions](#)

Number of contacts Low Voltage	4
Wire Size/AWG	26 - 22
Gender	Standard
Plug	Plug - Straight
Locking system	Ratchet
Jacket cable outside diameter [mm]	4.00 - 8.00 mm
Size	0M
Matching parts	PMP.0M.304.XLMT
Series	M - Rugged Ratchet coupling

Technical details

https://www.lemo.com/int_en/solutions/optima/m-ratchet-coupling/fmp-0m-304-xlct.html

LEMO products and services are provided "as is". LEMO makes no warranties or representations with regard to LEMO product & services or use of them, express, implied or statutory, including for accuracy, completeness, or security. The user is fully responsible for his products and applications using LEMO components.

Electrical Configuration

Contact Termination Low voltage	Crimp
R (max)	6.1 mOhm
Insert configuration value	0M.304 - 4 Low Voltage
Insulator	L: PEEK
Rated current	7 Amps
Test voltage (kV rms) Contact-contact	1.35
Test voltage (kV rms) Contact-shell	0.9
Contact retention	22 N
Contact Type	Crimp
Max. Conductor	0.34 mm ² (AWG 22)
Min. Conductor	0.14 mm ² (AWG 26)
Bucket Dia.	0.8 mm (0.031in)
Contact Dia.	0.7 mm (0.028in)
Number of contacts Low Voltage	4
Wire Size/AWG	26 - 22
Gender	Standard

Form & Material

Shell style / Model id	FM - Straight plug, key (N) or keys (P, R, S, T, U, V, W and X) with knurled grip and mold stop
Plug	Straight
Housing material	Aluminium (nickel plated [SAE AMS QQ N 290], anthracite color) shell and nut, other pieces bronze/brass
Locking system	Ratchet
Keying	3 keys (beta=150, gamma=60, plug: male contacts, receptacle: female contacts)
Weight	6.71 g

Cable fixation

Cable termination protection	For overmolding
Fixation type	T type cable adapter
Jacket cable outside diameter [mm]	4.00 - 8.00 mm

https://www.lemo.com/int_en/solutions/optima/m-ratchet-coupling/fmp-0m-304-xlct.html

LEMO products and services are provided "as is". LEMO makes no warranties or representations with regard to LEMO product & services or use of them, express, implied or statutory, including for accuracy, completeness, or security. The user is fully responsible for his products and applications using LEMO components.

Drawings

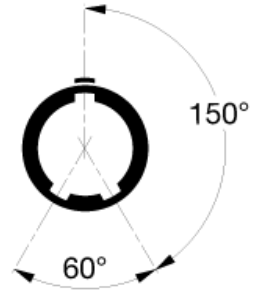
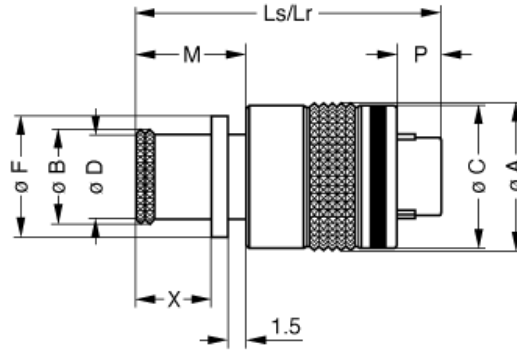

Dimensions

	A	B	C	D	F	Ls	Lr	M	P	X
mm.	13.1	8.8	12.7	8	10.7	27.1	27.1	9.7	3.9	6.7
in.	0.52	0.35	0.5	0.31	0.42	1.07	1.07	0.38	0.15	0.26

https://www.lemo.com/int_en/solutions/optima/m-ratchet-coupling/fmp-0m-304-xlct.html

LEMO products and services are provided "as is". LEMO makes no warranties or representations with regard to LEMO product & services or use of them, express, implied or statutory, including for accuracy, completeness, or security. The user is fully responsible for his products and applications using LEMO components.