



## Summary

[Request a quote](#)

[Catalog](#)

[See video assembly instructions](#)

Number of contacts Low Voltage	2
Wire Size/AWG	20 - 16
Gender	Standard
Plug	Plug - Straight
Locking system	Ratchet
Jacket cable outside diameter [mm]	4.85 - 9.70 mm
Size	1M
Matching parts	<a href="#">PMN.1M.302.XLMT</a>
Series	M - Rugged Ratchet coupling

## Technical details

[https://www.lemo.com/int\\_en/solutions/optima/m-ratchet-coupling/fmn-1m-302-xlct.html](https://www.lemo.com/int_en/solutions/optima/m-ratchet-coupling/fmn-1m-302-xlct.html)

LEMO products and services are provided "as is". LEMO makes no warranties or representations with regard to LEMO product & services or use of them, express, implied or statutory, including for accuracy, completeness, or security. The user is fully responsible for his products and applications using LEMO components.

## Electrical Configuration

Contact Termination Low voltage	Crimp
R (max)	3.6 mOhm
Insert configuration value	1M.302 - 2 Low Voltage
Insulator	L: PEEK
Rated current	19 Amps
Contact retention	40 N
Contact Type	Crimp
Max. Conductor	1 mm <sup>2</sup> (AWG 18)
Min. Conductor	0.5 mm <sup>2</sup> (AWG 20)
Bucket Dia.	1.4 mm (0.055in)
Contact Dia.	1.3 mm (0.051in)
Number of contacts Low Voltage	2
Wire Size/AWG	20 - 16
Gender	Standard

## Form & Material

Shell style / Model id	FM - Straight plug, key (N) or keys (P, R, S, T, U, V, W and X) with knurled grip and mold stop
Plug	Straight
Housing material	Aluminium (nickel plated [SAE AMS QQ N 290], anthracite color) shell and nut, other pieces bronze/brass
Locking system	Ratchet
Keying	3 keys (beta=165, gamma=30, plug: male contacts, receptacle: female contacts)
Weight	6.96 g

## Cable fixation

Cable termination protection	For overmolding
Fixation type	T type cable adapter
Jacket cable outside diameter [mm]	4.85 - 9.70 mm

[https://www.lemo.com/int\\_en/solutions/optima/m-ratchet-coupling/fmn-1m-302-xlct.html](https://www.lemo.com/int_en/solutions/optima/m-ratchet-coupling/fmn-1m-302-xlct.html)

LEMO products and services are provided "as is". LEMO makes no warranties or representations with regard to LEMO product & services or use of them, express, implied or statutory, including for accuracy, completeness, or security. The user is fully responsible for his products and applications using LEMO components.

# Drawings

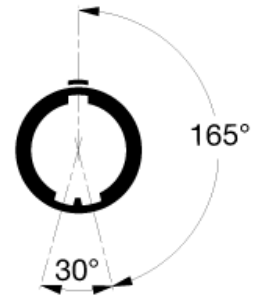
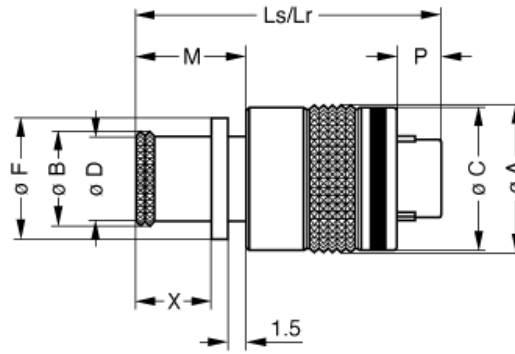

## Dimensions

	A	B	C	D	F	Ln	Lr	M	P	X
mm.	14.6	10.5	14.2	9.7	12.4	27.1	27.1	9.7	3.9	6.7
in.	0.57	0.41	0.56	0.38	0.49	1.07	1.07	0.38	0.15	0.26

## Recommended By Lemo

### Accessories

Replacement contact [FGN.0M.565.ZZC](#)

### Tools

Positionner [DCE.91.130.5MVC](#)







Extraction tool [DCF.93.131.4LT](#)

Crimp tool [DPC.91.701.V](#)

[https://www.lemo.com/int\\_en/solutions/optima/m-ratchet-coupling/fmn-1m-302-xlct.html](https://www.lemo.com/int_en/solutions/optima/m-ratchet-coupling/fmn-1m-302-xlct.html)

LEMO products and services are provided "as is". LEMO makes no warranties or representations with regard to LEMO product & services or use of them, express, implied or statutory, including for accuracy, completeness, or security. The user is fully responsible for his products and applications using LEMO components.

# Cables

Cable PartNumber	Material	Colour	Cable image
CMN.02.T18.064UNCU			
102080	PVC	Grey	
120184	PVC	Black	
120500	PVC	Grey	
120501	PVC	Grey	
120751	PVC	Grey	
220151	PVC	Grey	
220750	PVC	Grey	
320150	PVC	Grey	

[https://www.lemo.com/int\\_en/solutions/optima/m-ratchet-coupling/fmn-1m-302-xlct.html](https://www.lemo.com/int_en/solutions/optima/m-ratchet-coupling/fmn-1m-302-xlct.html)

LEMO products and services are provided "as is". LEMO makes no warranties or representations with regard to LEMO product & services or use of them, express, implied or statutory, including for accuracy, completeness, or security. The user is fully responsible for his products and applications using LEMO components.