



## Summary

[Request a quote](#)

[Catalog](#)

|                                    |                                |
|------------------------------------|--------------------------------|
| Number of contacts Low Voltage     | 8                              |
| Wire Size/AWG                      | 24 - 20                        |
| Gender                             | Reverse Gender                 |
| Plug                               | Plug - Straight                |
| Locking system                     | Ratchet                        |
| Jacket cable outside diameter [mm] | 6.50 - 13.00 mm                |
| Size                               | 2M                             |
| Matching parts                     | <a href="#">EGS.2M.308.XLC</a> |
| Series                             | M - Rugged Ratchet coupling    |

## Technical details

[https://www.lemo.com/int\\_en/solutions/optima/m-ratchet-coupling/fgs-2m-308-xlmt.html](https://www.lemo.com/int_en/solutions/optima/m-ratchet-coupling/fgs-2m-308-xlmt.html)

LEMO products and services are provided "as is". LEMO makes no warranties or representations with regard to LEMO product & services or use of them, express, implied or statutory, including for accuracy, completeness, or security. The user is fully responsible for his products and applications using LEMO components.

## Electrical Configuration

|                                       |                               |
|---------------------------------------|-------------------------------|
| Contact Termination Low voltage       | Crimp                         |
| R (max)                               | 4.8 mOhm                      |
| Insert configuration value            | 2M.308 - 8 Low Voltage        |
| Insulator                             | L: PEEK                       |
| Rated current                         | 10 Amps                       |
| Test voltage (kV rms) Contact-contact | 1.95                          |
| Test voltage (kV rms) Contact-shell   | 1.1                           |
| Contact retention                     | 30 N                          |
| Contact Type                          | Crimp                         |
| Max. Conductor                        | 0.5 mm <sup>2</sup> (AWG 20)  |
| Min. Conductor                        | 0.25 mm <sup>2</sup> (AWG 24) |
| Bucket Dia.                           | 1.1 mm (0.043in)              |
| Contact Dia.                          | 0.9 mm (0.035in)              |
| Number of contacts Low Voltage        | 8                             |
| Wire Size/AWG                         | 24 - 20                       |
| Gender                                | Reverse Gender                |

## Form & Material

|                        |   |
|------------------------|---|
| Shell style / Model id | FG - Straight plug with arctic grip and mold stop   |
| Plug                   | Straight  |
| Housing material       | Aluminium (nickel plated [SAE AMS QQ N 290], anthracite color) shell and nut, other pieces bronze/brass |
| Locking system         | Ratchet   |
| Keying                 | 3 keys (beta=155, gamma=50, plug: female contacts, receptacle: male contacts)                           |
| Weight                 | 10.3 g  |

## Cable fixation

|                                    |                      |
|------------------------------------|----------------------|
| Cable termination protection       | For overmolding      |
| Fixation type                      | T type cable adapter |
| Jacket cable outside diameter [mm] | 6.50 - 13.00 mm      |

[https://www.lemo.com/int\\_en/solutions/optima/m-ratchet-coupling/fgs-2m-308-xlmt.html](https://www.lemo.com/int_en/solutions/optima/m-ratchet-coupling/fgs-2m-308-xlmt.html)

LEMO products and services are provided "as is". LEMO makes no warranties or representations with regard to LEMO product & services or use of them, express, implied or statutory, including for accuracy, completeness, or security. The user is fully responsible for his products and applications using LEMO components.

# Drawings

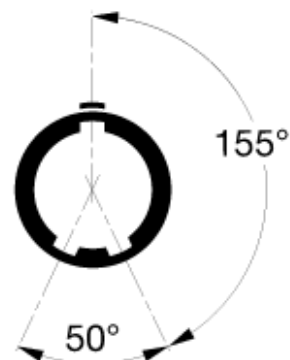
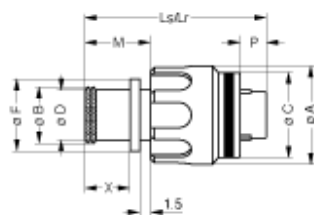
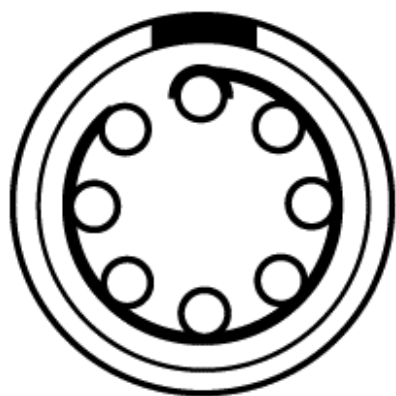

## Dimensions

|     | <b>A</b> | <b>B</b> | <b>C</b> | <b>D</b> | <b>F</b> | <b>Ls</b> | <b>Lr</b> | <b>M</b> | <b>P</b> | <b>X</b> |
|-----|----------|----------|----------|----------|----------|-----------|-----------|----------|----------|----------|
| mm. | 18.9     | 14       | 17.2     | 13       | 15.5     | 27.5      | 27.5      | 10.1     | 3.9      | 7.1      |
| in. | 0.74     | 0.55     | 0.68     | 0.51     | 0.61     | 1.08      | 1.08      | 0.4      | 0.15     | 0.28     |

[https://www.lemo.com/int\\_en/solutions/optima/m-ratchet-coupling/fgs-2m-308-xlmt.html](https://www.lemo.com/int_en/solutions/optima/m-ratchet-coupling/fgs-2m-308-xlmt.html)

LEMO products and services are provided "as is". LEMO makes no warranties or representations with regard to LEMO product & services or use of them, express, implied or statutory, including for accuracy, completeness, or security. The user is fully responsible for his products and applications using LEMO components.