

Summary

[Request a quote](#)

[Catalog](#)

Number of contacts Low Voltage	1
Locking system	Push-pull
Size	1S
Matching parts	FFA.1S.120.CTAC27
Series	S - Indoor Stepped Insert

Technical details

Electrical Configuration

Insert configuration value	1S.120 - 1 Low Voltage
Insulator	T: PTFE
Rated current	18 Amps
Number of contacts Low Voltage	1

Form & Material

Shell style / Model id	RMA - Free coupler
Housing material	Brass (chrome plated [SAE AMS 2460]) shell and collet nut, nickel plated [SAE AMS QQ N 290] brass latch sleeve and mid pieces
Locking system	Push-pull
Keying	Circular, female
Weight	14.1 g

https://www.lemo.com/int_en/solutions/originals/s-indoor-stepped-insert/rma-1s-120-ctm.html

LEMO products and services are provided "as is". LEMO makes no warranties or representations with regard to LEMO product & services or use of them, express, implied or statutory, including for accuracy, completeness, or security. The user is fully responsible for his products and applications using LEMO components.

Environment

Technical domain	Audio Video, Energy and Industrial, Semiconductor, Test and Measurement
Environmental sealing (IP rating)	IP50
Endurance	5000 mating cycles
Temperature range	-55°C / +250°C
Climatical Category	50/175/21
Humidity (max)	<=95% [at 60 deg C /140 F]
Shielding (min)	75 dB (10 MHz)
Shielding (min)	40 dB (1 GHz)
Shock Resistance	100 g [6 ms]
Vibration	15 g [10 Hz - 2000 Hz]
Salt Spray Corrosion	>1000 hr

Drawings

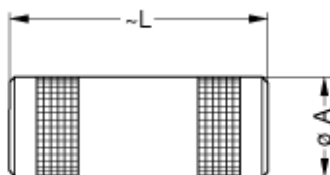

Dimensions

	A	L
mm.	11.9	28.5
in.	0.47	1.12

https://www.lemo.com/int_en/solutions/originals/s-indoor-stepped-insert/rma-1s-120-ctm.html

LEMO products and services are provided "as is". LEMO makes no warranties or representations with regard to LEMO product & services or use of them, express, implied or statutory, including for accuracy, completeness, or security. The user is fully responsible for his products and applications using LEMO components.