



Image for illustrative purpose only

Summary

[Request a quote](#)

[Catalog](#)

| | |
|------------------------------------|---|
| Number of contacts Low Voltage | 10 |
| Wire Size/AWG | 28 - 20 |
| Socket / Receptacle | Socket / Receptacle - Fixed Panel Front Mounted |
| Locking system | Push-pull |
| Jacket cable outside diameter [mm] | 7.30 - 8.70 mm |
| Size | 3S |
| Suggested matching part | FFP.3S.310.CLAC87 |
| Series | S - Indoor Stepped Insert |

https://www.lemo.com/int_en/solutions/originals/s-indoor-stepped-insert/psp-3s-310-cllc87.html

LEMO products and services are provided "as is". LEMO makes no warranties or representations with regard to LEMO product & services or use of them, express, implied or statutory, including for accuracy, completeness, or security. The user is fully responsible for his products and applications using LEMO components.

Technical details

Electrical Configuration

| | |
|---------------------------------|------------------------------|
| Contact Termination Low voltage | Solder |
| R (max) | 3.6 mOhm |
| Insert configuration value | 3S.310 - 10 Low Voltage |
| Insulator | L: PEEK (UL 94 / V-0/1.5) |
| Rated current | 9 A |
| Vtest | 1060 V (AC), 1500 V (DC) |
| Contact Type | Solder |
| Max. Solid Conductor | 0.5 mm ² (AWG 20) |
| Max. Stranded Conductor | 0.5 mm ² (AWG 20) |
| Bucket Dia. | 1 mm (0.039in) |
| Contact Dia. | 1.3 mm (0.051in) |
| Number of contacts Low Voltage | 10 |
| Wire Size/AWG | 28 - 20 |

Form & Material

| | |
|------------------------|---|
| Shell style / Model id | PSP - Fixed receptacle, nut fixing, cable collet and inner anti-rotating device |
| Socket / Receptacle | Fixed Panel Front Mounted |
| Housing material | Brass (chrome plated [SAE AMS 2460]) shell and collet nut, nickel plated [SAE AMS QQ N 290] brass latch sleeve and mid pieces |
| Locking system | Push-pull |
| Keying | Hermaphroditic keying (half moon insert) with female pin 1 |
| Colour | Grey |
| Weight | 56.04 g |

https://www.lemo.com/int_en/solutions/originals/s-indoor-stepped-insert/psp-3s-310-cllc87.html

LEMO products and services are provided "as is". LEMO makes no warranties or representations with regard to LEMO product & services or use of them, express, implied or statutory, including for accuracy, completeness, or security. The user is fully responsible for his products and applications using LEMO components.

Environment

| | |
|-----------------------------------|---|
| Technical domain | Audio Video, Energy and Industrial, Semiconductor, Test and Measurement |
| Environmental sealing (IP rating) | IP50 |
| Endurance | 5000 mating cycles |
| Temperature range | -55°C / +250°C |
| Climatical Category | 50/175/21 |
| Humidity (max) | <=95% [at 60 deg C /140 F] |
| Shielding (min) | 75 dB (10 MHz) |
| Shielding (min) | 40 dB (1 GHz) |
| Shock Resistance | 100 g [6 ms] |
| Vibration | 15 g [10 Hz - 2000 Hz] |
| Salt Spray Corrosion | >1000 hr |

Cable fixation

| | |
|------------------------------------|--|
| Cable termination protection | Standard back nut (no additional protection) |
| Fixation type | Cable collet |
| Jacket cable outside diameter [mm] | 7.30 - 8.70 mm |

Drawings

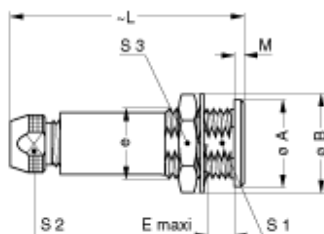
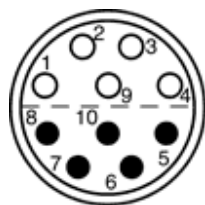

Dimensions

| | A | B | e | E | L | M | S1 | S2 | S3 |
|-----|----------|----------|----------|----------|----------|----------|-----------|-----------|-----------|
| mm. | 22 | 25.2 | M18x1.0 | 11.5 | 59 | 2 | 16.5 | 14 | 22 |
| in. | 0.87 | 0.99 | | 0.45 | 2.32 | 0.08 | 0.65 | 0.55 | 0.87 |

https://www.lemo.com/int_en/solutions/originals/s-indoor-stepped-insert/psp-3s-310-cllc87.html

LEMO products and services are provided "as is". LEMO makes no warranties or representations with regard to LEMO product & services or use of them, express, implied or statutory, including for accuracy, completeness, or security. The user is fully responsible for his products and applications using LEMO components.

Recommended By Lemo



Accessories

Tools

Spanner wrench

[DCP.91.023.TN](#)

Cables

| Cable PartNumber | Material | Colour | Cable image |
|--------------------|----------|--------|---|
| CMN.10.T20.080PGZE | | grey |  |
| CMN.10.T20.080PNZE | | |  |
| CMN.10.T20.080QGC | TPR | Grey | |
| 110220 | PVC | Black |  |

https://www.lemo.com/int_en/solutions/originals/s-indoor-stepped-insert/psp-3s-310-cllc87.html

LEMO products and services are provided "as is". LEMO makes no warranties or representations with regard to LEMO product & services or use of them, express, implied or statutory, including for accuracy, completeness, or security. The user is fully responsible for his products and applications using LEMO components.