



Image for illustrative purpose only

Summary

[Request a quote](#)

[Catalog](#)

Number of contacts High Voltage	1
Socket / Receptacle	Socket / Receptacle - Fixed Panel Front Mounted
Locking system	Push-pull
Jacket cable outside diameter [mm]	4.30 - 5.70 mm
Size	3S
Series	S - Indoor Stepped Insert

https://www.lemo.com/int_en/solutions/originals/s-indoor-stepped-insert/psa-3s-415-cllc57.html

LEMO products and services are provided "as is". LEMO makes no warranties or representations with regard to LEMO product & services or use of them, express, implied or statutory, including for accuracy, completeness, or security. The user is fully responsible for his products and applications using LEMO components.

Technical details

Electrical Configuration

Contact Termination High voltage	Solder
Insert configuration value	3S.415 - 1 High Voltage
Insulator	L: PEEK (UL 94 / V-0/1.5)
Rated current	8 A
Test voltage (kV DC)	21
Contact Type	Solder
Creepage distance	28.5 mm
Number of contacts High Voltage	1

Form & Material

Shell style / Model id	PSA - Fixed receptacle, nut fixing, cable collet
Socket / Receptacle	Fixed Panel Front Mounted
Housing material	Brass (chrome plated [SAE AMS 2460]) shell and collet nut, nickel plated [SAE AMS QQ N 290] brass latch sleeve and mid pieces
Locking system	Push-pull
Keying	Circular, female
Colour	Grey
Weight	65.98 g

Environment

Technical domain	Audio Video, Energy and Industrial, Semiconductor, Test and Measurement
Environmental sealing (IP rating)	IP50
Endurance	5000 mating cycles
Temperature range	-55°C / +250°C
Climatical Category	50/175/21
Humidity (max)	<=95% [at 60 deg C /140 F]
Shielding (min)	75 dB (10 MHz)
Shielding (min)	40 dB (1 GHz)
Shock Resistance	100 g [6 ms]
Vibration	15 g [10 Hz - 2000 Hz]
Salt Spray Corrosion	>1000 hr

https://www.lemo.com/int_en/solutions/originals/s-indoor-stepped-insert/psa-3s-415-cllc57.html

LEMO products and services are provided "as is". LEMO makes no warranties or representations with regard to LEMO product & services or use of them, express, implied or statutory, including for accuracy, completeness, or security. The user is fully responsible for his products and applications using LEMO components.

Cable fixation

Cable termination protection	Standard back nut (no additional protection)
Fixation type	Cable collet
Jacket cable outside diameter [mm]	4.30 - 5.70 mm

Drawings

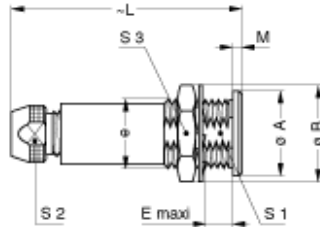
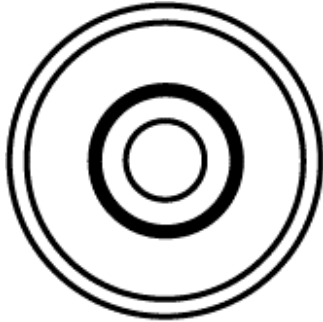

Dimensions

	A	B	e	E	L	M	S1	S2	S3
mm.	22	25.2	M18x1.0	11.5	59	2	16.5	14	22
in.	0.87	0.99		0.45	2.32	0.08	0.65	0.55	0.87

https://www.lemo.com/int_en/solutions/originals/s-indoor-stepped-insert/psa-3s-415-cllc57.html

LEMO products and services are provided "as is". LEMO makes no warranties or representations with regard to LEMO product & services or use of them, express, implied or statutory, including for accuracy, completeness, or security. The user is fully responsible for his products and applications using LEMO components.