



Image for illustrative purpose only

Summary

[Request a quote](#)

[Catalog](#)

Nb of contacts Thermocouple	4
Socket / Receptacle	Socket / Receptacle - Fixed Panel Front Mounted
Locking system	Push-pull
Jacket cable outside diameter [mm]	6.60 - 7.00 mm
Size	2E
Suggested matching part	FFA.2E.902.CLKC70
Series	E - Outdoor Stepped Insert

https://www.lemo.com/int_en/solutions/originals/e-outdoor-stepped-insert/psa-2e-902-clkc70.html

LEMO products and services are provided "as is". LEMO makes no warranties or representations with regard to LEMO product & services or use of them, express, implied or statutory, including for accuracy, completeness, or security. The user is fully responsible for his products and applications using LEMO components.

Technical details

Electrical Configuration

Nb of contacts Thermocouple	4
Contact Termination Thermocouple	Solder
Insert configuration value	2E.902/ThC - 2 Thermocouple Pairs
Insulator	L: PEEK (UL 94 / V-0/1.5)
Rated current	12 A

Form & Material

Shell style / Model id	PSA - Fixed receptacle, nut fixing, cable collet
Socket / Receptacle	Fixed Panel Front Mounted
Housing material	Brass (chrome plated [SAE AMS 2460]) shell, collet nut and latch sleeve, nickel plated [SAE AMS QQ N 290] brass mid pieces
Locking system	Push-pull
Keying	Hermaphroditic keying (half moon insert) with female pin 1
Colour	Grey
Weight	61.66 g

Environment

Technical domain	Energy and Industrial, Test and Measurement
Environmental sealing (IP rating)	IP68
Endurance	5000 mating cycles
Temperature range	-55°C / +200°C (max. temperature valid for short periods of use.)
Climatical Category	50/175/21
Humidity (max)	<=95% [at 60 deg C /140 F]
Shielding (min)	95 dB (10 MHz)
Shielding (min)	80 dB (1 GHz)
Shock Resistance	100 g [6 ms]
Vibration	15 g [10 Hz - 2000 Hz]
Salt Spray Corrosion	>1000 hr

https://www.lemo.com/int_en/solutions/originals/e-outdoor-stepped-insert/psa-2e-902-clkc70.html

LEMO products and services are provided "as is". LEMO makes no warranties or representations with regard to LEMO product & services or use of them, express, implied or statutory, including for accuracy, completeness, or security. The user is fully responsible for his products and applications using LEMO components.

Cable fixation

Cable termination protection	Standard back nut (no additional protection)
Fixation type	Cable collet
Jacket cable outside diameter [mm]	6.60 - 7.00 mm

Drawings

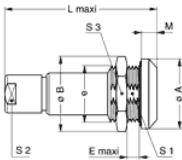
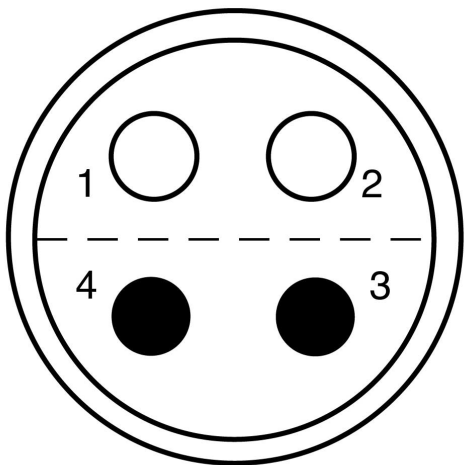

Contact 1, 3: Chromel (+)
Contact 2, 4: Alumel (-)

Dimensions

	A	B	e	E	L	M	S1	S2	S3
mm.	25	27.5	M20x1.0	9	54	5	18.5	12	24
in.	0.98	1.08		0.35	2.13	0.2	0.73	0.47	0.94

Recommended By Lemo

Accessories

Compatible cap	BRE.2K.200.NAS
----------------	--------------------------------