



## Summary

[Request a quote](#)

[Catalog](#)

Nb of contacts Coax	1
Socket / Receptacle	Socket / Receptacle - Fixed Panel Front Mounted
Locking system	Push-pull
Jacket cable outside diameter [mm]	5.10 - 5.50 mm
Size	2E
Series	E - Outdoor Stepped Insert

[https://www.lemo.com/int\\_en/solutions/originals/e-outdoor-stepped-insert/psa-2e-250-ctlc55.html](https://www.lemo.com/int_en/solutions/originals/e-outdoor-stepped-insert/psa-2e-250-ctlc55.html)

LEMO products and services are provided "as is". LEMO makes no warranties or representations with regard to LEMO product & services or use of them, express, implied or statutory, including for accuracy, completeness, or security. The user is fully responsible for his products and applications using LEMO components.

# Technical details

## Electrical Configuration

Nb of contacts Coax	1
Contact Termination Coax	Solder
Insert configuration value	2E.250 - 1 Coax (50 Ohm)
Insulator	T: PTFE
Rated current	15 A
Impedance	50 Ohm
VSWR	1.02 + 0.95 * f/GHz
Vtest	3000 V (AC), 4200 V (DC)
Contact Type	Solder
Cable type	RG 58 C/U, RG 302 /U, RG 400 /U, 2YCCY, RG 59 B/U, RG 223 /U, HF-5408

## Form & Material

Shell style / Model id	PSA - Fixed receptacle, nut fixing, cable collet
Socket / Receptacle	Fixed Panel Front Mounted
Housing material	Brass (chrome plated [SAE AMS 2460]) shell, collet nut and latch sleeve, nickel plated [SAE AMS QQ N 290] brass mid pieces
Locking system	Push-pull
Keying	Circular, female
Weight	62.86 g

## Environment

Technical domain	Energy and Industrial, Test and Measurement
Environmental sealing (IP rating)	IP68
Endurance	5000 mating cycles
Temperature range	-55°C / +200°C
Climatical Category	50/175/21
Humidity (max)	<=95% [at 60 deg C /140 F]
Shielding (min)	95 dB (10 MHz)
Shielding (min)	80 dB (1 GHz)
Shock Resistance	100 g [ 6 ms]
Vibration	15 g [10 Hz - 2000 Hz]
Salt Spray Corrosion	>1000 hr

[https://www.lemo.com/int\\_en/solutions/originals/e-outdoor-stepped-insert/psa-2e-250-ctlc55.html](https://www.lemo.com/int_en/solutions/originals/e-outdoor-stepped-insert/psa-2e-250-ctlc55.html)

LEMO products and services are provided "as is". LEMO makes no warranties or representations with regard to LEMO product & services or use of them, express, implied or statutory, including for accuracy, completeness, or security. The user is fully responsible for his products and applications using LEMO components.

## Cable fixation

Cable termination protection	Standard back nut (no additional protection)
Fixation type	Cable collet
Jacket cable outside diameter [mm]	5.10 - 5.50 mm

## Drawings

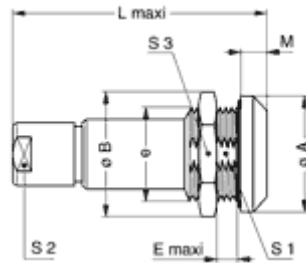

## Dimensions

	<b>A</b>	<b>B</b>	<b>e</b>	<b>E</b>	<b>L</b>	<b>M</b>	<b>S1</b>	<b>S2</b>	<b>S3</b>
mm.	25	27.5	M20x1.0	9	54	5	18.5	12	24
in.	0.98	1.08		0.35	2.13	0.2	0.73	0.47	0.94

[https://www.lemo.com/int\\_en/solutions/originals/e-outdoor-stepped-insert/psa-2e-250-ctlc55.html](https://www.lemo.com/int_en/solutions/originals/e-outdoor-stepped-insert/psa-2e-250-ctlc55.html)

LEMO products and services are provided "as is". LEMO makes no warranties or representations with regard to LEMO product & services or use of them, express, implied or statutory, including for accuracy, completeness, or security. The user is fully responsible for his products and applications using LEMO components.