



Image for illustrative purpose only

Summary

[Request a quote](#)

[Catalog](#)

| | |
|------------------------------------|---|
| Number of contacts Low Voltage | 5 |
| Socket / Receptacle | Socket / Receptacle - Fixed Panel Front Mounted |
| Locking system | Push-pull |
| Jacket cable outside diameter [mm] | 5.10 - 5.50 mm |
| Size | 1E |
| Suggested matching part | FFA.1E.305.CLAC55 |
| Series | E - Outdoor Stepped Insert |

https://www.lemo.com/int_en/solutions/originals/e-outdoor-stepped-insert/psa-1e-305-cllc55.html

LEMO products and services are provided "as is". LEMO makes no warranties or representations with regard to LEMO product & services or use of them, express, implied or statutory, including for accuracy, completeness, or security. The user is fully responsible for his products and applications using LEMO components.

Technical details

Electrical Configuration

| | |
|---------------------------------|---|
| Number of contacts Low Voltage | 5 |
| Contact Termination Low voltage | Solder |
| Insert configuration value | 1E.305 - 2 (0.9 mm) + 3 (0.7 mm) Low Voltage |
| Insulator | L: PEEK (UL 94 / V-0/1.5) |
| Rated current | 2x0.9 contacts : 10 Amps and 3x0,7 contacts : 7 A |
| Test voltage (kV DC) | 2.1 |

Form & Material

| | |
|------------------------|--|
| Shell style / Model id | PSA - Fixed receptacle, nut fixing, cable collet |
| Socket / Receptacle | Fixed Panel Front Mounted |
| Housing material | Brass (chrome plated [SAE AMS 2460]) shell, collet nut and latch sleeve, nickel plated [SAE AMS QQ N 290] brass mid pieces |
| Locking system | Push-pull |
| Keying | Hermaphroditic keying (half moon insert) with female pin 1 |
| Colour | Grey |

Environment

| | |
|-----------------------------------|---|
| Technical domain | Energy and Industrial, Test and Measurement |
| Environmental sealing (IP rating) | IP68 |
| Endurance | 5000 mating cycles |
| Temperature range | -55°C / +200°C |
| Climatical Category | 50/175/21 |
| Humidity (max) | <=95% [at 60 deg C /140 F] |
| Shielding (min) | 95 dB (10 MHz) |
| Shielding (min) | 80 dB (1 GHz) |
| Shock Resistance | 100 g [6 ms] |
| Vibration | 15 g [10 Hz - 2000 Hz] |
| Salt Spray Corrosion | >1000 hr |

https://www.lemo.com/int_en/solutions/originals/e-outdoor-stepped-insert/psa-1e-305-cllc55.html

LEMO products and services are provided "as is". LEMO makes no warranties or representations with regard to LEMO product & services or use of them, express, implied or statutory, including for accuracy, completeness, or security. The user is fully responsible for his products and applications using LEMO components.

Cable fixation

| | |
|------------------------------------|--|
| Cable termination protection | Standard back nut (no additional protection) |
| Fixation type | Cable collet |
| Jacket cable outside diameter [mm] | 5.10 - 5.50 mm |

Drawings

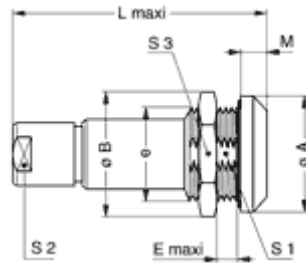

Dimensions

| | A | B | e | E | L | M | S1 | S2 | S3 |
|-----|------|------|---------|------|------|------|------|------|------|
| mm. | 20 | 21.5 | M16x1.0 | 9 | 45 | 4.5 | 14.5 | 9 | 19 |
| in. | 0.79 | 0.85 | | 0.35 | 1.77 | 0.18 | 0.57 | 0.35 | 0.75 |

Recommended By Lemo

Accessories

Compatible cap

[BRE.1K.200.NAS](#)

https://www.lemo.com/int_en/solutions/originals/e-outdoor-stepped-insert/psa-1e-305-cllc55.html

LEMO products and services are provided "as is". LEMO makes no warranties or representations with regard to LEMO product & services or use of them, express, implied or statutory, including for accuracy, completeness, or security. The user is fully responsible for his products and applications using LEMO components.