



Image for illustrative purpose only

Summary

[Request a quote](#)

[Catalog](#)

| | |
|------------------------------------|---|
| Number of contacts Low Voltage | 5 |
| Wire Size/AWG | 30 - 22 |
| Gender | Reverse Gender |
| Socket / Receptacle | Socket / Receptacle - Fixed Panel Front Mounted |
| Locking system | Push-pull |
| Jacket cable outside diameter [mm] | 6.10 - 6.50 mm |
| Size | 1K |
| Series | K - Outdoor keyed |

https://www.lemo.com/int_en/solutions/originals/k-outdoor-keyed/pkl-1k-305-clac65z.html

LEMO products and services are provided "as is". LEMO makes no warranties or representations with regard to LEMO product & services or use of them, express, implied or statutory, including for accuracy, completeness, or security. The user is fully responsible for his products and applications using LEMO components.

Technical details

Electrical Configuration

| | |
|---------------------------------|-------------------------------|
| Number of contacts Low Voltage | 5 |
| Contact Termination Low voltage | Solder |
| R (max) | 4.8 mOhm |
| Insert configuration value | 1K.305 - 5 Low Voltage |
| Insulator | L: PEEK (UL 94 / V-0/1.5) |
| Rated current | 9 A |
| Vtest (contact-contact) | 1.8 kV (DC) |
| Vtest (contact-shell) | 1.7 kV (DC) |
| Max. Solid Conductor | 0.34 mm ² (AWG 22) |
| Max. Stranded Conductor | 0.34 mm ² (AWG 22) |
| Bucket Dia. | 0.8 mm (0.031in) |
| Contact Dia. | 0.9 mm (0.035in) |
| Wire Size/AWG | 30 - 22 |
| Gender | Reverse Gender |

Form & Material

| | |
|------------------------|--|
| Shell style / Model id | PK - Fixed receptacle, nut fixing, cable collet and nut for fitting a bend relief |
| Socket / Receptacle | Fixed Panel Front Mounted |
| Housing material | Brass (chrome plated [SAE AMS 2460]) shell, collet nut and latch sleeve, nickel plated [SAE AMS QQ N 290] brass mid pieces |
| Locking system | Push-pull |
| Keying | 2 keys (gamma=75, plug: female contacts, receptacle: male contacts) |
| Colour | Grey |
| Weight | 32.23 g |

https://www.lemo.com/int_en/solutions/originals/k-outdoor-keyed/pkl-1k-305-clac65z.html

LEMO products and services are provided "as is". LEMO makes no warranties or representations with regard to LEMO product & services or use of them, express, implied or statutory, including for accuracy, completeness, or security. The user is fully responsible for his products and applications using LEMO components.

Environment

| | |
|-----------------------------------|---|
| Technical domain | Audio Video, Energy and Industrial, Medical, Test and Measurement |
| Environmental sealing (IP rating) | IP68 |
| Endurance | 5000 mating cycles |
| Temperature range | -55°C / +200°C |
| Climatical Category | 50/175/21 |
| Humidity (max) | <=95% [at 60 deg C /140 F] |
| Shielding (min) | 95 dB (10 MHz) |
| Shielding (min) | 80 dB (1 GHz) |
| Shock Resistance | 100 g [6 ms] |
| Vibration | 15 g [10 Hz - 2000 Hz] |
| Salt Spray Corrosion | >1000 hr |

Cable fixation

| | |
|------------------------------------|-----------------------|
| Cable termination protection | For cable bend relief |
| Fixation type | Cable collet |
| Jacket cable outside diameter [mm] | 6.10 - 6.50 mm |

Drawings

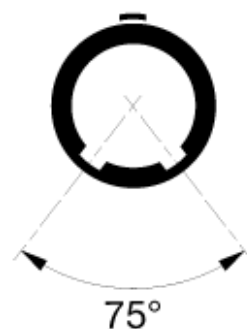
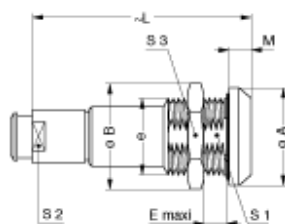

Dimensions

| | A | B | e | E | L | M | S1 | S2 | S3 |
|-----|------|------|---------|------|------|------|------|------|------|
| mm. | 20 | 21.5 | M16x1.0 | 9.5 | 46.2 | 4.5 | 14.5 | 9 | 19 |
| in. | 0.79 | 0.85 | | 0.37 | 1.82 | 0.18 | 0.57 | 0.35 | 0.75 |

https://www.lemo.com/int_en/solutions/originals/k-outdoor-keyed/pkl-1k-305-clac65z.html

LEMO products and services are provided "as is". LEMO makes no warranties or representations with regard to LEMO product & services or use of them, express, implied or statutory, including for accuracy, completeness, or security. The user is fully responsible for his products and applications using LEMO components.

Recommended By Lemo

Accessories

Compatible cap

[BRE.1K.200.NAS](#)

https://www.lemo.com/int_en/solutions/originals/k-outdoor-keyed/pkl-1k-305-clac65z.html

LEMO products and services are provided “as is”. LEMO makes no warranties or representations with regard to LEMO product & services or use of them, express, implied or statutory, including for accuracy, completeness, or security. The user is fully responsible for his products and applications using LEMO components.