



Image for illustrative purpose only

## Summary

[Request a quote](#)

[Catalog](#)

Number of contacts Low Voltage	7
Wire Size/AWG	32 - 24
Gender	Standard
Socket / Receptacle	Socket / Receptacle - Fixed Panel Rear Mounted
Locking system	Push-pull
Jacket cable outside diameter [mm]	1.00 - 12.60 mm
Size	1P
Suggested matching part	<a href="#">PAG.M0.7TL.AC65N</a>
Series	REDEL P - Push-Pull

[https://www.lemo.com/int\\_en/solutions/redel/redel-p-push-pull/pkg-m0-7tl-la.html](https://www.lemo.com/int_en/solutions/redel/redel-p-push-pull/pkg-m0-7tl-la.html)

LEMO products and services are provided "as is". LEMO makes no warranties or representations with regard to LEMO product & services or use of them, express, implied or statutory, including for accuracy, completeness, or security. The user is fully responsible for his products and applications using LEMO components.

# Technical details

## Electrical Configuration

Contact Termination Low voltage	Solder
R (max)	6.5 mOhm
Insert configuration value	1P.M07 - 7 Low Voltage
Insulator	L: PEEK (UL 94 / V-0/1.5)
Rated current	5 A
Test voltage contact-contact	1.48 (kV DC)
Contact Type	Solder
Max. Solid Conductor	0.25 mm <sup>2</sup> (AWG 24)
Max. Stranded Conductor	0.14 mm <sup>2</sup> (AWG 26)
Air clearance	0.85 mm
Creepage distance	0.85 mm
Bucket Dia.	0.6 mm (0.024in)
Contact Dia.	0.7 mm (0.0275in)
Number of contacts Low Voltage	7
Wire Size/AWG	32 - 24
Gender	Standard

## Form & Material

Shell style / Model id	PK - Fixed receptacle with two nuts (back panel mounting)
Socket / Receptacle	Fixed Panel Rear Mounted
Housing material	PEI (Polyetherimide), black
Locking system	Push-pull
Keying	G: 1 key (alpha=0, plug: male contacts, receptacle: female contacts)
Colour	Black - Blue
Variant	Blue front nut

[https://www.lemo.com/int\\_en/solutions/redel/redel-p-push-pull/pkg-m0-7tl-la.html](https://www.lemo.com/int_en/solutions/redel/redel-p-push-pull/pkg-m0-7tl-la.html)

LEMO products and services are provided "as is". LEMO makes no warranties or representations with regard to LEMO product & services or use of them, express, implied or statutory, including for accuracy, completeness, or security. The user is fully responsible for his products and applications using LEMO components.

## Environment

Technical domain	Energy and Industrial, Medical, Test and Measurement, Transportation, Aerospace and UAV
Environmental sealing (IP rating)	IP50
Endurance	> 5000 mating cycles
Temperature range	-50°C / +170°C
F ret (max)	150 N
F ret (min)	50 N
Steam sterilization	Fully sterilizable (Steam, Gamma, ETO) following our protocols and tests in line with ISO 11134 and IEC 60601-1 standards. For more details on sterilization methods and cycles, please contact us.

## Cable fixation

Cable termination protection	Standard back nut (no additional protection)
Fixation type	Cable collet
Jacket cable outside diameter [mm]	1.00 - 12.60 mm

## Drawings

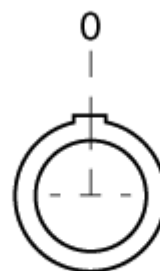

## Dimensions

	<b>A</b>	<b>a</b>	<b>N</b>
mm.	19.5	0-4.5	20.5-22.2
in.	0.77		

[https://www.lemo.com/int\\_en/solutions/redel/redel-p-push-pull/pkg-m0-7tl-la.html](https://www.lemo.com/int_en/solutions/redel/redel-p-push-pull/pkg-m0-7tl-la.html)

LEMO products and services are provided "as is". LEMO makes no warranties or representations with regard to LEMO product & services or use of them, express, implied or statutory, including for accuracy, completeness, or security. The user is fully responsible for his products and applications using LEMO components.

# Recommended By Lemo









## Accessories

Compatible cap [PBG.200.BMV](#)

## Tools

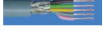
Spanner [POB.186.GN](#)

# Cables

Cable PartNumber	Material	Colour	Cable image
CMN.07.T26.037QGZE	TPR (medical)	Grey	
CMN.07.T28.044PGZE		grey	
CMN.07.T28.044PNZE			
270250	PVC	Grey	
70140	PVC	Grey	
7041	PVC	Grey	
7050	PVC	Black	
717920	PVC	Grey	
CTR.75.030.121875G	PVC	Grey	

[https://www.lemo.com/int\\_en/solutions/redel/redel-p-push-pull/pkg-m0-7tl-la.html](https://www.lemo.com/int_en/solutions/redel/redel-p-push-pull/pkg-m0-7tl-la.html)

LEMO products and services are provided "as is". LEMO makes no warranties or representations with regard to LEMO product & services or use of them, express, implied or statutory, including for accuracy, completeness, or security. The user is fully responsible for his products and applications using LEMO components.