



*Image for illustrative purpose only*

## Summary

[Request a quote](#)

[Catalog](#)

Number of contacts Low Voltage	10
Wire Size/AWG	34 - 28
Gender	Standard
Socket / Receptacle	Socket / Receptacle - Fixed Panel Front Mounted
Locking system	Push-pull
Jacket cable outside diameter [mm]	8.10 - 8.50 mm
Size	1K
Suggested matching part	<a href="#">FGG.1K.310.CLAK85</a>
Series	K - Outdoor keyed

[https://www.lemo.com/int\\_en/solutions/originals/k-outdoor-keyed/pkg-1k-310-cllk85.html](https://www.lemo.com/int_en/solutions/originals/k-outdoor-keyed/pkg-1k-310-cllk85.html)

LEMO products and services are provided "as is". LEMO makes no warranties or representations with regard to LEMO product & services or use of them, express, implied or statutory, including for accuracy, completeness, or security. The user is fully responsible for his products and applications using LEMO components.

# Technical details

## Electrical Configuration

Number of contacts Low Voltage	10
Contact Termination Low voltage	Solder
R (max)	8.7 mOhm
Insert configuration value	1K.310 - 10 Low Voltage
Insulator	L: PEEK (UL 94 / V-0/1.5)
Rated current	2 A
Vtest (contact-contact)	1.3 kV (DC)
Vtest (contact-shell)	2.1 kV (DC)
Max. Solid Conductor	0.09 mm <sup>2</sup> (AWG 28)
Max. Stranded Conductor	0.09 mm <sup>2</sup> (AWG 28)
Bucket Dia.	0.45 mm (0.018in)
Contact Dia.	0.5 mm (0.02in)
Wire Size/AWG	34 - 28
Gender	Standard

## Form & Material

Shell style / Model id	PK - Fixed receptacle, nut fixing, cable collet
Socket / Receptacle	Fixed Panel Front Mounted
Housing material	Brass (chrome plated [SAE AMS 2460]) shell, collet nut and latch sleeve, nickel plated [SAE AMS QQ N 290] brass mid pieces
Locking system	Push-pull
Keying	G: 1 key (alpha=0, plug: male contacts, receptacle: female contacts)
Colour	Grey
Weight	45.53 g

[https://www.lemo.com/int\\_en/solutions/originals/k-outdoor-keyed/pkg-1k-310-cllk85.html](https://www.lemo.com/int_en/solutions/originals/k-outdoor-keyed/pkg-1k-310-cllk85.html)

LEMO products and services are provided "as is". LEMO makes no warranties or representations with regard to LEMO product & services or use of them, express, implied or statutory, including for accuracy, completeness, or security. The user is fully responsible for his products and applications using LEMO components.

## Environment

Technical domain	Audio Video, Energy and Industrial, Medical, Test and Measurement
Environmental sealing (IP rating)	IP68
Endurance	5000 mating cycles
Temperature range	-55°C / +200°C
Climatical Category	50/175/21
Humidity (max)	<=95% [at 60 deg C /140 F]
Shielding (min)	95 dB (10 MHz)
Shielding (min)	80 dB (1 GHz)
Shock Resistance	100 g [ 6 ms]
Vibration	15 g [10 Hz - 2000 Hz]
Salt Spray Corrosion	>1000 hr

## Cable fixation

Cable termination protection	Standard back nut (no additional protection)
Fixation type	Cable collet
Jacket cable outside diameter [mm]	8.10 - 8.50 mm

## Drawings

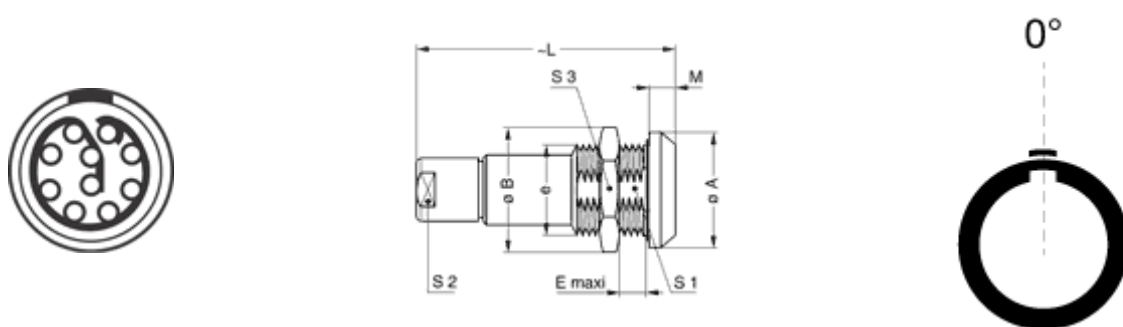

## Dimensions

	A	B	e	E	L	M	S1	S2	S3
mm.	20	21.5	M16x1.0	9.5	46.2	4.5	14.5	9	19
in.	0.79	0.85		0.37	1.82	0.18	0.57	0.35	0.75

[https://www.lemo.com/int\\_en/solutions/originals/k-outdoor-keyed/pkg-1k-310-cllk85.html](https://www.lemo.com/int_en/solutions/originals/k-outdoor-keyed/pkg-1k-310-cllk85.html)

LEMO products and services are provided "as is". LEMO makes no warranties or representations with regard to LEMO product & services or use of them, express, implied or statutory, including for accuracy, completeness, or security. The user is fully responsible for his products and applications using LEMO components.

# Recommended By Lemo

## Accessories

---

Compatible cap

[BRE.1K.200.NAS](#)

[https://www.lemo.com/int\\_en/solutions/originals/k-outdoor-keyed/pkg-1k-310-cllk85.html](https://www.lemo.com/int_en/solutions/originals/k-outdoor-keyed/pkg-1k-310-cllk85.html)

LEMO products and services are provided “as is”. LEMO makes no warranties or representations with regard to LEMO product & services or use of them, express, implied or statutory, including for accuracy, completeness, or security. The user is fully responsible for his products and applications using LEMO components.