

Image for illustrative purpose only

Summary

[Request a quote](#)

[Catalog](#)

Number of contacts Low Voltage	4
Wire Size/AWG	28 - 20
Socket / Receptacle	Socket / Receptacle - Free
Locking system	Push-pull
Size	2L
Suggested matching part	FGG.2L.304.CLAC70

https://www.lemo.com/int_en/phg-2l-304-cllc70.html

LEMO products and services are provided "as is". LEMO makes no warranties or representations with regard to LEMO product & services or use of them, express, implied or statutory, including for accuracy, completeness, or security. The user is fully responsible for his products and applications using LEMO components.

Technical details

Electrical Configuration

Contact Termination Low voltage	Solder
Rated current	15 A
Contact Type	Solder
Contact Dia.	1.3
Number of contacts Low Voltage	4
Wire Size/AWG	28 - 20

Form & Material

Shell style / Model id	PH - Free socket, cable collet
Socket / Receptacle	Free
Housing material	Brass (chrome plated [SAE AMS 2460]) shell and collet nut, nickel plated [SAE AMS QQ N 290] brass latch sleeve and mid pieces
Locking system	Push-pull
Keying	Hermaphroditic keying (half moon insert) with female pin 1
Weight	45.05 g

Environment

Environmental sealing (IP rating)	IP66
Temperature range	-55°C / +200°C
Salt Spray Corrosion	>1000 hr

Cable fixation

Cable termination protection	Standard back nut (no additional protection)
------------------------------	--

Drawings

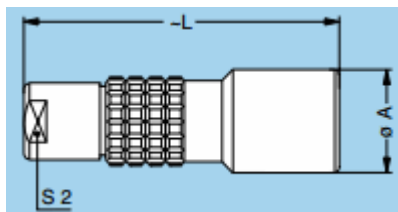

https://www.lemo.com/int_en/phg-2l-304-cllc70.html

LEMO products and services are provided "as is". LEMO makes no warranties or representations with regard to LEMO product & services or use of them, express, implied or statutory, including for accuracy, completeness, or security. The user is fully responsible for his products and applications using LEMO components.

Dimensions

	A	L	S2
mm.	19	54	12
in.	0.75	2.13	0.47

https://www.lemo.com/int_en/phg-2l-304-cllc70.html

LEMO products and services are provided "as is". LEMO makes no warranties or representations with regard to LEMO product & services or use of them, express, implied or statutory, including for accuracy, completeness, or security. The user is fully responsible for his products and applications using LEMO components.