



*Image for illustrative purpose only*

## Summary

[Request a quote](#)

[Catalog](#)

Number of contacts Low Voltage	8
Wire Size/AWG	20 - 18
Gender	Reverse Gender
Socket / Receptacle	Socket / Receptacle - Fixed Panel Rear Mounted
Locking system	Push-pull
Jacket cable outside diameter [mm]	9.60 - 10.00 mm
Size	3K
Series	K - Outdoor keyed

[https://www.lemo.com/int\\_en/solutions/originals/k-outdoor-keyed/pel-3k-308-sycc10.html](https://www.lemo.com/int_en/solutions/originals/k-outdoor-keyed/pel-3k-308-sycc10.html)

LEMO products and services are provided "as is". LEMO makes no warranties or representations with regard to LEMO product & services or use of them, express, implied or statutory, including for accuracy, completeness, or security. The user is fully responsible for his products and applications using LEMO components.

# Technical details

## Electrical Configuration

Number of contacts Low Voltage	8
Contact Termination Low voltage	Crimp
R (max)	3.6 mOhm
Insert configuration value	3K.308 - 8 Low Voltage
Insulator	Y: PEEK for crimp contacts
Rated current	13 A
Vtest (contact-contact)	2.6 kV (DC)
Vtest (contact-shell)	2.5 kV (DC)
Contact retention	40 N
Max. Conductor	1 mm <sup>2</sup> (AWG 18)
Min. Conductor	0.5 mm <sup>2</sup> (AWG 20)
Bucket Dia.	1.4 mm (0.055in)
Contact Dia.	1.3 mm (0.051in)
Wire Size/AWG	20 - 18
Gender	Reverse Gender

## Form & Material

Shell style / Model id	PE - Fixed receptacle, nut fixing, cable collet (back panel mounting)
Socket / Receptacle	Fixed Panel Rear Mounted
Housing material	Stainless steel shell and collet nut, nickel plated [SAE AMS QQ N 290] brass latch sleeve and mid pieces
Locking system	Push-pull
Keying	2 keys (gamma=75, plug: female contacts, receptacle: male contacts)
Colour	Grey
Weight	103.58 g

[https://www.lemo.com/int\\_en/solutions/originals/k-outdoor-keyed/pel-3k-308-sycc10.html](https://www.lemo.com/int_en/solutions/originals/k-outdoor-keyed/pel-3k-308-sycc10.html)

LEMO products and services are provided "as is". LEMO makes no warranties or representations with regard to LEMO product & services or use of them, express, implied or statutory, including for accuracy, completeness, or security. The user is fully responsible for his products and applications using LEMO components.

## Environment

Technical domain	Audio Video, Energy and Industrial, Medical, Test and Measurement
Environmental sealing (IP rating)	IP68
Endurance	5000 mating cycles
Temperature range	-55°C / +200°C (max. temperature valid for short periods of use.)
Climatical Category	50/175/21
Humidity (max)	<=95% [at 60 deg C /140 F]
Shielding (min)	95 dB (10 MHz)
Shielding (min)	80 dB (1 GHz)
Shock Resistance	100 g [ 6 ms]
Vibration	15 g [10 Hz - 2000 Hz]

## Cable fixation

Cable termination protection	Standard back nut (no additional protection)
Fixation type	Cable collet
Jacket cable outside diameter [mm]	9.60 - 10.00 mm

## Drawings

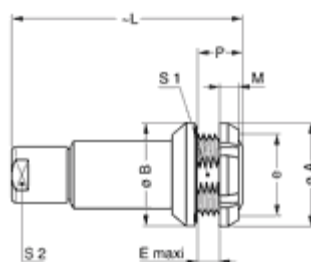

## Dimensions

	A	P	M	L	E	e	B	S1	S2
mm.	30	12	4.5	65	7.5	M24x1.0	31	22.5	15
in.	1.18	0.47	0.18	2.56	0.3		1.22	0.89	0.59

[https://www.lemo.com/int\\_en/solutions/originals/k-outdoor-keyed/pel-3k-308-sycc10.html](https://www.lemo.com/int_en/solutions/originals/k-outdoor-keyed/pel-3k-308-sycc10.html)

LEMO products and services are provided "as is". LEMO makes no warranties or representations with regard to LEMO product & services or use of them, express, implied or statutory, including for accuracy, completeness, or security. The user is fully responsible for his products and applications using LEMO components.

# Recommended By Lemo

Accessories	
Replacement contact	<a href="#">FGG.3B.565.ZZC</a>
Tools	
Positionner	<a href="#">DCE.91.133.BVC</a>
Extraction tool	<a href="#">DCC.13.15B.LAG</a>
Crimp tool	<a href="#">DPC.91.701.V</a>
Spanner wrench	<a href="#">Socket for torque wrench DCM.65.270.AZ</a>

## Cables

Cable PartNumber	Material	Colour	Cable image
380750	PVC	Grey	