



*Image for illustrative purpose only*

## Summary

[Request a quote](#)

[Catalog](#)

Number of contacts Low Voltage	12
Wire Size/AWG	24 - 20
Gender	Standard
Socket / Receptacle	Socket / Receptacle - Fixed Panel Rear Mounted
Locking system	Push-pull
Jacket cable outside diameter [mm]	9.90 - 11.00 mm
Size	3B
Suggested matching part	<a href="#">FGG.3B.312.CYCD11Z</a>
Series	B - Indoor keyed

[https://www.lemo.com/int\\_en/solutions/originals/b-indoor-keyed/peg-3b-312-cymd11z.html](https://www.lemo.com/int_en/solutions/originals/b-indoor-keyed/peg-3b-312-cymd11z.html)

LEMO products and services are provided "as is". LEMO makes no warranties or representations with regard to LEMO product & services or use of them, express, implied or statutory, including for accuracy, completeness, or security. The user is fully responsible for his products and applications using LEMO components.

# Technical details

## Electrical Configuration

Number of contacts Low Voltage	12
Contact Termination Low voltage	Crimp
R (max)	4.8 mOhm
Insert configuration value	3B.312 - 12 Low Voltage
Insulator	Y: PEEK for crimp contacts
Rated current	9 A
Vtest (contact-contact)	2.3 kV (DC)
Vtest (contact-shell)	2.6 kV (DC)
Contact retention	30 N
Max. Conductor	0.5 mm <sup>2</sup> (AWG 20)
Min. Conductor	0.25 mm <sup>2</sup> (AWG 24)
Bucket Dia.	1.1 mm (0.043in)
Contact Dia.	0.9 mm (0.035in)
Wire Size/AWG	24 - 20
Gender	Standard

## Form & Material

Shell style / Model id	PE - Fixed receptacle, nut fixing, cable collet (back panel mounting) and nut for fitting a bend relief
Socket / Receptacle	Fixed Panel Rear Mounted
Housing material	Brass (chrome plated [SAE AMS 2460]) shell and collet nut, nickel plated [SAE AMS QQ N 290] brass latch sleeve and mid pieces
Locking system	Push-pull
Keying	G: 1 key (alpha=0, plug: male contacts, receptacle: female contacts)
Colour	Grey
Variant	Nut for fitting a bend relief
Weight	60.01 g

[https://www.lemo.com/int\\_en/solutions/originals/b-indoor-keyed/peg-3b-312-cymd11z.html](https://www.lemo.com/int_en/solutions/originals/b-indoor-keyed/peg-3b-312-cymd11z.html)

LEMO products and services are provided "as is". LEMO makes no warranties or representations with regard to LEMO product & services or use of them, express, implied or statutory, including for accuracy, completeness, or security. The user is fully responsible for his products and applications using LEMO components.

## Environment

Technical domain	Audio Video, Energy and Industrial, Medical, Semiconductor, Specialties and Other, Test and Measurement, Transportation, Aerospace and UAV
Environmental sealing (IP rating)	IP50
Endurance	5000 mating cycles
Temperature range	-55°C / +250°C (max. temperature valid for short periods of use.)
Climatical Category	50/175/21
Humidity (max)	<=95% [at 60 deg C /140 F]
Shielding (min)	75 dB (10 MHz)
Shielding (min)	40 dB (1 GHz)
Shock Resistance	100 g [ 6 ms]
Vibration	15 g [10 Hz - 2000 Hz]
Salt Spray Corrosion	>1000 hr

## Cable fixation

Cable termination protection	For cable bend relief
Fixation type	Cable collet
Jacket cable outside diameter [mm]	9.90 - 11.00 mm

## Drawings

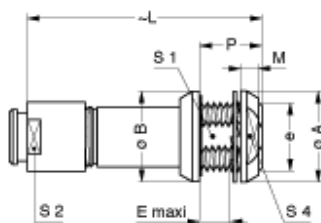

## Dimensions

	S4	P	A	B	e	E	L	M	S1	S2
mm.	20	12	24	25	M18x1.0	5	54.5	4.5	16.5	15
in.	0.79	0.47	0.94	0.98		0.2	2.15	0.18	0.65	0.59

[https://www.lemo.com/int\\_en/solutions/originals/b-indoor-keyed/peg-3b-312-cymd11z.html](https://www.lemo.com/int_en/solutions/originals/b-indoor-keyed/peg-3b-312-cymd11z.html)

LEMO products and services are provided "as is". LEMO makes no warranties or representations with regard to LEMO product & services or use of them, express, implied or statutory, including for accuracy, completeness, or security. The user is fully responsible for his products and applications using LEMO components.

# Recommended By Lemo

Accessories	
Replacement contact	<a href="#">EGG.3B.660.ZZM</a>
Tools	
Positionner	<a href="#">DCE.91.093.BVM</a>
Extraction tool	<a href="#">DCC.09.05B.LAG</a>
Crimp tool	<a href="#">DPC.91.701.V</a>
Spanner wrench	<a href="#">Socket for torque wrench DCM.65.200.AZ</a>