



## Summary

[Request a quote](#)

[Catalog](#)

Number of contacts Low Voltage	6
Wire Size/AWG	20 - 18
Gender	Standard
Socket / Receptacle	Socket / Receptacle - Fixed Panel Rear Mounted
Locking system	Push-pull
Jacket cable outside diameter [mm]	7.60 - 8.00 mm
Size	2K
Suggested matching part	<a href="#">FGG.2K.306.CYCC80</a>
Series	K - Outdoor keyed

[https://www.lemo.com/int\\_en/solutions/originals/k-outdoor-keyed/peg-2k-306-cymc80.html](https://www.lemo.com/int_en/solutions/originals/k-outdoor-keyed/peg-2k-306-cymc80.html)

LEMO products and services are provided "as is". LEMO makes no warranties or representations with regard to LEMO product & services or use of them, express, implied or statutory, including for accuracy, completeness, or security. The user is fully responsible for his products and applications using LEMO components.

# Technical details

## Electrical Configuration

Contact Termination Low voltage	Crimp
R (max)	3.6 mOhm
Insert configuration value	2K.306 - 6 Low Voltage
Insulator	Y: PEEK for crimp contacts
Rated current	12 A
Vtest (contact-contact)	2000 V (AC), 2850 V (DC)
Vtest (contact-shell)	2350 V (AC), 3320 V (DC)
Contact retention	40 N
Contact Type	Crimp
Max. Conductor	1 mm <sup>2</sup> (AWG 18)
Min. Conductor	0.5 mm <sup>2</sup> (AWG 20)
Bucket Dia.	1.4 mm (0.055in)
Contact Dia.	1.3 mm (0.051in)
Number of contacts Low Voltage	6
Wire Size/AWG	20 - 18
Gender	Standard

## Form & Material

Shell style / Model id	PE - Fixed receptacle, nut fixing, cable collet (back panel mounting)
Socket / Receptacle	Fixed Panel Rear Mounted
Housing material	Brass (chrome plated [SAE AMS 2460]) shell, collet nut and latch sleeve, nickel plated [SAE AMS QQ N 290] brass mid pieces
Locking system	Push-pull
Keying	1 key (alpha=0, plug: male contacts, receptacle: female contacts)
Weight	57.98 g

[https://www.lemo.com/int\\_en/solutions/originals/k-outdoor-keyed/peg-2k-306-cymc80.html](https://www.lemo.com/int_en/solutions/originals/k-outdoor-keyed/peg-2k-306-cymc80.html)

LEMO products and services are provided "as is". LEMO makes no warranties or representations with regard to LEMO product & services or use of them, express, implied or statutory, including for accuracy, completeness, or security. The user is fully responsible for his products and applications using LEMO components.

## Environment

Technical domain	Audio Video, Energy and Industrial, Medical, Test and Measurement
Environmental sealing (IP rating)	IP68
Endurance	5000 mating cycles
Temperature range	-55°C / +200°C
Climatical Category	50/175/21
Humidity (max)	<=95% [at 60 deg C /140 F]
Shielding (min)	95 dB (10 MHz)
Shielding (min)	80 dB (1 GHz)
Shock Resistance	100 g [ 6 ms]
Vibration	15 g [10 Hz - 2000 Hz]
Salt Spray Corrosion	>1000 hr

## Cable fixation

Cable termination protection	Standard back nut (no additional protection)
Fixation type	Cable collet
Jacket cable outside diameter [mm]	7.60 - 8.00 mm

## Drawings

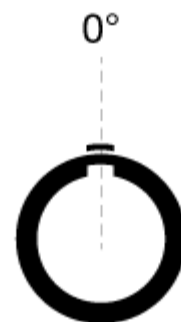
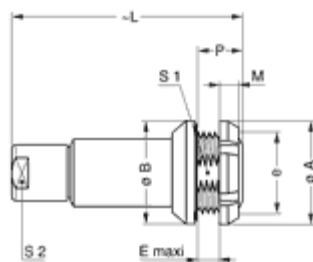

## Dimensions

	<b>S1</b>	<b>P</b>	<b>M</b>	<b>L</b>	<b>E</b>	<b>e</b>	<b>B</b>	<b>A</b>	<b>S2</b>
mm.	18.5	7.5	3.5	54	4	M20x1.0	25	25	12
in.	0.73	0.3	0.14	2.13	0.16		0.98	0.98	0.47

[https://www.lemo.com/int\\_en/solutions/originals/k-outdoor-keyed/peg-2k-306-cymc80.html](https://www.lemo.com/int_en/solutions/originals/k-outdoor-keyed/peg-2k-306-cymc80.html)

LEMO products and services are provided "as is". LEMO makes no warranties or representations with regard to LEMO product & services or use of them, express, implied or statutory, including for accuracy, completeness, or security. The user is fully responsible for his products and applications using LEMO components.