



Image for illustrative purpose only

Summary

[Request a quote](#)

[Catalog](#)

Number of contacts Low Voltage	3
Wire Size/AWG	16 - 12
Gender	Standard
Socket / Receptacle	Socket / Receptacle - Fixed Panel Rear Mounted
Locking system	Push-pull
Jacket cable outside diameter [mm]	7.80 - 9.20 mm
Size	3B
Series	B - Indoor keyed

https://www.lemo.com/int_en/solutions/originals/b-indoor-keyed/peb-3b-303-cymd82z.html

LEMO products and services are provided "as is". LEMO makes no warranties or representations with regard to LEMO product & services or use of them, express, implied or statutory, including for accuracy, completeness, or security. The user is fully responsible for his products and applications using LEMO components.

Technical details

Electrical Configuration

Number of contacts Low Voltage	3
Contact Termination Low voltage	Crimp
R (max)	3.3 mOhm
Insert configuration value	3B.303 - 3 Low Voltage
Insulator	Y: PEEK for crimp contacts
Rated current	25 A
Vtest (contact-contact)	4.5 kV (DC)
Vtest (contact-shell)	3.8 kV (DC)
Contact retention	65 N
Max. Conductor	2.5 mm ² (AWG 12)
Min. Conductor	1.5 mm ² (AWG 16)
Bucket Dia.	2.4 mm (0.094in)
Contact Dia.	2 mm (0.079in)
Wire Size/AWG	16 - 12
Gender	Standard

Form & Material

Shell style / Model id	PE - Fixed receptacle, nut fixing, cable collet (back panel mounting) and nut for fitting a bend relief
Socket / Receptacle	Fixed Panel Rear Mounted
Housing material	Brass (chrome plated [SAE AMS 2460]) shell and collet nut, nickel plated [SAE AMS QQ N 290] brass latch sleeve and mid pieces
Locking system	Push-pull
Keying	B: 2 keys (alpha=45, plug: male contacts, receptacle: female contacts)
Colour	Grey
Variant	Nut for fitting a bend relief

https://www.lemo.com/int_en/solutions/originals/b-indoor-keyed/peb-3b-303-cymd82z.html

LEMO products and services are provided "as is". LEMO makes no warranties or representations with regard to LEMO product & services or use of them, express, implied or statutory, including for accuracy, completeness, or security. The user is fully responsible for his products and applications using LEMO components.

Environment

Technical domain	Audio Video, Energy and Industrial, Medical, Semiconductor, Specialties and Other, Test and Measurement, Transportation, Aerospace and UAV
Environmental sealing (IP rating)	IP50
Endurance	5000 mating cycles
Temperature range	-55°C / +250°C (max. temperature valid for short periods of use.)
Climatical Category	50/175/21
Humidity (max)	<=95% [at 60 deg C /140 F]
Shielding (min)	75 dB (10 MHz)
Shielding (min)	40 dB (1 GHz)
Shock Resistance	100 g [6 ms]
Vibration	15 g [10 Hz - 2000 Hz]
Salt Spray Corrosion	>1000 hr

Cable fixation

Cable termination protection	For cable bend relief
Fixation type	Cable collet
Jacket cable outside diameter [mm]	7.80 - 9.20 mm

Drawings

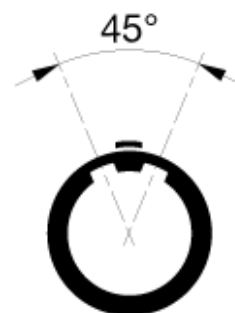
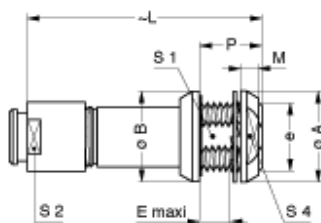

Dimensions

	S4	P	A	B	e	E	L	M	S1	S2
mm.	20	12	24	25	M18x1.0	5	54.5	4.5	16.5	15
in.	0.79	0.47	0.94	0.98		0.2	2.15	0.18	0.65	0.59

https://www.lemo.com/int_en/solutions/originals/b-indoor-keyed/peb-3b-303-cymd82z.html

LEMO products and services are provided "as is". LEMO makes no warranties or representations with regard to LEMO product & services or use of them, express, implied or statutory, including for accuracy, completeness, or security. The user is fully responsible for his products and applications using LEMO components.

Recommended By Lemo

Accessories	
Replacement contact	EGG.3B.675.ZZM
Tools	
Positionner	DCE.91.203.BVCM
Extraction tool	DCC.20.25B.LAG
Crimp tool	DPC.91.101.A
Spanner wrench	Socket for torque wrench DCM.65.200.AZ

Cables

Cable PartNumber	Material	Colour	Cable image
CMN.03.T14.078PGCE			
330150	PVC	Grey	