



## Summary

[Request a quote](#)

[Catalog](#)

Number of contacts Low Voltage	5
Wire Size/AWG	24 - 20
Gender	Standard
Plug	Plug - Straight
Locking system	Push-pull
Jacket cable outside diameter [mm]	2.70 - 3.90 mm
Size	1P
Matching parts	<a href="#">PLG.M0.5GL.MG</a>
Series	REDEL P - Push-Pull

## Technical details

[https://www.lemo.com/int\\_en/solutions/redel/redel-p-push-pull/pag-m0-5gl-cc39g.html](https://www.lemo.com/int_en/solutions/redel/redel-p-push-pull/pag-m0-5gl-cc39g.html)

LEMO products and services are provided "as is". LEMO makes no warranties or representations with regard to LEMO product & services or use of them, express, implied or statutory, including for accuracy, completeness, or security. The user is fully responsible for his products and applications using LEMO components.

## Electrical Configuration

Contact Termination Low voltage	Crimp
R (max)	4.5 mOhm
Insert configuration value	1P.M05 - 5 Low Voltage
Insulator	L: PEEK (UL 94 / V-0/1.5)
Rated current	7 Amps
Test voltage (kV rms) Contact-contact	1.05
Contact retention	24 N
Contact Type	Crimp
Max. Conductor	0.25 mm <sup>2</sup> (AWG 24)
Min. Conductor	0.5 mm <sup>2</sup> (AWG 20)
Air clearance	1.1 mm
Creepage distance	1.1 mm
Bucket Dia.	1.1
Contact Dia.	0.9 mm (0.0354in)
Number of contacts Low Voltage	5
Wire Size/AWG	24 - 20
Gender	Standard

## Form & Material

Shell style / Model id	PA - Straight plug with cable collet
Plug	Straight
Housing material	PSU (Polysulfone), gray
Locking system	Push-pull
Keying	1 key (alpha=0, Plug: male contact, Receptacle: female contact)
Variant	Gray collet nut
Weight	6.87 g

[https://www.lemo.com/int\\_en/solutions/redel/redel-p-push-pull/pag-m0-5gl-cc39g.html](https://www.lemo.com/int_en/solutions/redel/redel-p-push-pull/pag-m0-5gl-cc39g.html)

LEMO products and services are provided "as is". LEMO makes no warranties or representations with regard to LEMO product & services or use of them, express, implied or statutory, including for accuracy, completeness, or security. The user is fully responsible for his products and applications using LEMO components.

## Environment

Technical domain	Energy and Industrial, Medical, Test and Measurement, Transportation, Aerospace and UAV
Environmental protection (IP rating)	IP50
Minimal temperature	-50°C / +150°C
F ret (max)	150 N
F ret (min)	50 N
Steam sterilization	> 100 times (with potting on rear connection)

## Cable fixation

Cable termination protection	Standard back nut (no additional protection)
Fixation type	Cable collet
Jacket cable outside diameter [mm]	2.70 - 3.90 mm

## Drawings

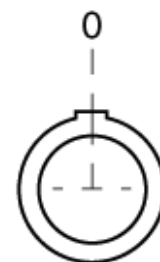

## Recommended By Lemo

### Accessories

Replacement contact [SINGLE: FGG.5B.562.ZZC KIT OF 5: PAG.562.05C](#)

### Tools

Positionner [DCE.91.095.BVD](#)





Extraction tool [DCC.09.05B.LAG](#)

Crimp tool [DPC.91.701.V](#)

[https://www.lemo.com/int\\_en/solutions/redel/redel-p-push-pull/pag-m0-5gl-cc39g.html](https://www.lemo.com/int_en/solutions/redel/redel-p-push-pull/pag-m0-5gl-cc39g.html)

LEMO products and services are provided "as is". LEMO makes no warranties or representations with regard to LEMO product & services or use of them, express, implied or statutory, including for accuracy, completeness, or security. The user is fully responsible for his products and applications using LEMO components.

# Cables

Cable PartNumber	Material	Colour	Cable image
CMN.05.T28.029PGCE	PVC	GREY	
CMN.05.T28.029PGZE		grey	
CMN.05.T28.029PNCE	PVC	Black	
CMN.05.T28.029PNZE			
5050	PVC	Black	

[https://www.lemo.com/int\\_en/solutions/redel/redel-p-push-pull/pag-m0-5gl-cc39g.html](https://www.lemo.com/int_en/solutions/redel/redel-p-push-pull/pag-m0-5gl-cc39g.html)

LEMO products and services are provided "as is". LEMO makes no warranties or representations with regard to LEMO product & services or use of them, express, implied or statutory, including for accuracy, completeness, or security. The user is fully responsible for his products and applications using LEMO components.