



Summary

[Request a quote](#)

[Catalog](#)

| | |
|--------|---------------------------|
| Size | 2S |
| Series | S - Indoor Stepped Insert |

Technical details

Form & Material

| | |
|------------------------|-------------------------|
| Shell style / Model id | GRA - Insulating washer |
| Housing material | Polyamide, black |
| Keying | No keying |
| Weight | 0.32 g |

Environment

| | |
|--------------------------------------|---|
| Technical domain | Audio Video, Energy and Industrial, Semiconductor, Test and Measurement |
| Environmental protection (IP rating) | No IP rating |
| Minimal temperature | -50°C / +90°C |
| Climatical Category | 50/175/21 |
| Humidity (max) | <=95% [at 60 deg C /140 F] |
| Shielding (min) | 75 dB (10 MHz) |
| Shielding (min) | 40 dB (1 GHz) |
| Shock Resistance | 100 g [6 ms] |
| Vibration | 15 g [10 Hz - 2000 Hz] |

https://www.lemo.com/int_en/solutions/originals/s-indoor-stepped-insert/gra-2s-269-gn.html

LEMO products and services are provided "as is". LEMO makes no warranties or representations with regard to LEMO product & services or use of them, express, implied or statutory, including for accuracy, completeness, or security. The user is fully responsible for his products and applications using LEMO components.

Drawings

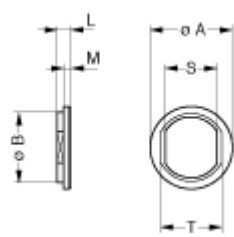

No keying

Dimensions

| | A | B | L | M | S | T |
|-----|------|------|------|------|------|------|
| mm. | 21.1 | 17.9 | 2.3 | 1.3 | 13.6 | 16.2 |
| in. | 0.83 | 0.7 | 0.09 | 0.05 | 0.54 | 0.64 |