



Summary

[Request a quote](#)

[Catalog](#)

Size	2S
Series	S - Indoor Stepped Insert

Technical details

Electrical Configuration

Insulator	N: PBT (discontinued)
-----------	-----------------------

Form & Material

Shell style / Model id	GEA - Hexagonal nuts
Housing material	Aluminum alloy (anodized) shell and collet nut, nickel plated [SAE AMS QQ N 290] brass latch sleeve and mid pieces
Keying	No keying
Weight	2.02 g

https://www.lemo.com/int_en/solutions/originals/s-indoor-stepped-insert/gea-2s-240-ln.html

LEMO products and services are provided "as is". LEMO makes no warranties or representations with regard to LEMO product & services or use of them, express, implied or statutory, including for accuracy, completeness, or security. The user is fully responsible for his products and applications using LEMO components.

Environment

Technical domain	Audio Video, Energy and Industrial, Semiconductor, Test and Measurement
Environmental protection (IP rating)	No IP rating
Minimal temperature	-55°C / +250°C
Climatical Category	50/175/21
Humidity (max)	<=95% [at 60 deg C /140 F]
Shielding (min)	75 dB (10 MHz)
Shielding (min)	40 dB (1 GHz)
Shock Resistance	100 g [6 ms]
Vibration	15 g [10 Hz - 2000 Hz]

Drawings

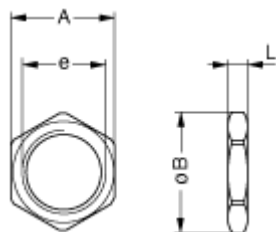

No keying

Dimensions

	A	B	e	L
mm.	17	19.2	M15x1.0	2.7
in.	0.67	0.76		0.11

https://www.lemo.com/int_en/solutions/originals/s-indoor-stepped-insert/gea-2s-240-ln.html

LEMO products and services are provided "as is". LEMO makes no warranties or representations with regard to LEMO product & services or use of them, express, implied or statutory, including for accuracy, completeness, or security. The user is fully responsible for his products and applications using LEMO components.