



*Image for illustrative purpose only*

## Summary

[Request a quote](#)

---

[Catalog](#)

---

Nb of contacts Coax	1
Size	1E
Series	E - Outdoor Stepped Insert

[https://www.lemo.com/int\\_en/solutions/originals/e-outdoor-stepped-insert/gba-1e-250-fn.html](https://www.lemo.com/int_en/solutions/originals/e-outdoor-stepped-insert/gba-1e-250-fn.html)

LEMO products and services are provided "as is". LEMO makes no warranties or representations with regard to LEMO product & services or use of them, express, implied or statutory, including for accuracy, completeness, or security. The user is fully responsible for his products and applications using LEMO components.

# Technical details

## Electrical Configuration

Nb of contacts Coax	1
Rated current	12 A
OHM	50
Cable type	RG 178 B/U, RG 196 A/U, RG 188 A/U, RG 316 B/U, RG 174 A/U, HF-2114, RG 122 /U

## Form & Material

Shell style / Model id	GBA - Locking washer
Housing material	Bronze (nickel plated [SAE AMS QQ N 290]) washer
Keying	No keying
Weight	0.88 g

## Environment

Technical domain	Energy and Industrial, Test and Measurement
Environmental sealing (IP rating)	No IP rating
Temperature range	-55°C / +200°C
Climatical Category	50/175/21
Humidity (max)	<=95% [at 60 deg C /140 F]
Shielding (min)	95 dB (10 MHz)
Shielding (min)	80 dB (1 GHz)
Shock Resistance	100 g [ 6 ms]
Vibration	15 g [10 Hz - 2000 Hz]

## Drawings

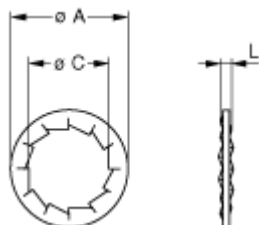

No keying

[https://www.lemo.com/int\\_en/solutions/originals/e-outdoor-stepped-insert/gba-1e-250-fn.html](https://www.lemo.com/int_en/solutions/originals/e-outdoor-stepped-insert/gba-1e-250-fn.html)

LEMO products and services are provided "as is". LEMO makes no warranties or representations with regard to LEMO product & services or use of them, express, implied or statutory, including for accuracy, completeness, or security. The user is fully responsible for his products and applications using LEMO components.

## Dimensions

	<b>A</b>	<b>C</b>	<b>L</b>
mm.	21.8	16.1	1.2
in.	0.86	0.63	0.05

[https://www.lemo.com/int\\_en/solutions/originals/e-outdoor-stepped-insert/gba-1e-250-fn.html](https://www.lemo.com/int_en/solutions/originals/e-outdoor-stepped-insert/gba-1e-250-fn.html)

LEMO products and services are provided "as is". LEMO makes no warranties or representations with regard to LEMO product & services or use of them, express, implied or statutory, including for accuracy, completeness, or security. The user is fully responsible for his products and applications using LEMO components.