



*Image for illustrative purpose only*

## Summary

[Request a quote](#)

[Catalog](#)

Number of contacts Low Voltage	2
Number of contacts High Voltage	2
Nb of contacts Fiber optic	2
Wire Size/AWG	24 - 20
Plug	Plug - Fixed
Locking system	Push-pull
Size	3K
Series	3K.93C.Y - SMPTE Hybrid

[https://www.lemo.com/int\\_en/solutions/specialties/3k-93c-y-smp-te-hybrid/fxw-3k-93c-tlx.html](https://www.lemo.com/int_en/solutions/specialties/3k-93c-y-smp-te-hybrid/fxw-3k-93c-tlx.html)

LEMO products and services are provided "as is". LEMO makes no warranties or representations with regard to LEMO product & services or use of them, express, implied or statutory, including for accuracy, completeness, or security. The user is fully responsible for his products and applications using LEMO components.

# Technical details

## Electrical Configuration

Number of contacts Low Voltage	2
Contact Termination Low voltage	Crimp
Number of contacts High Voltage	2
Contact Termination High voltage	Crimp
Nb of contacts Fiber optic	2
Insert configuration value	3K.93C - 2 FO Type F2, 2 HV + 2 LV
Insulator	L: PEEK (UL 94 / V-0/1.5)
Rated current	10 A
Fiber Optic Contact	Type F2
Vtest power/signal (AC)	2250V , 1000V
Working voltage power/signal(AC)	600V , 42V
Cable type	SMPTE 311M or EBU R100
Wire Size/AWG	24 - 20

## Form & Material

Shell style / Model id	FX - Fixed plug with round flange (4 hole fixing) without collet
Plug	Fixed
Housing material	Stainless steel shell, collet nut and latch sleeve, nickel plated [SAE AMS QQ N 290] brass mid pieces
Locking system	Push-pull
Keying	5 keys (alpha=95, beta=115, gamma=20, delta=30, plug: female LV, male HV, female FO contacts)
Colour	Grey
Weight	126.79 g

[https://www.lemo.com/int\\_en/solutions/specialties/3k-93c-y-smp-te-hybrid/fxw-3k-93c-tlx.html](https://www.lemo.com/int_en/solutions/specialties/3k-93c-y-smp-te-hybrid/fxw-3k-93c-tlx.html)

LEMO products and services are provided "as is". LEMO makes no warranties or representations with regard to LEMO product & services or use of them, express, implied or statutory, including for accuracy, completeness, or security. The user is fully responsible for his products and applications using LEMO components.

## Environment

Environmental sealing (IP rating)	IP50
Endurance	20000 mating cycles
Temperature range	-40°C / +80°C
Climatical Category	50/175/21
Humidity (max)	<=95% [at 60 deg C /140 F]
Shielding (min)	95 dB (10 MHz)
Shielding (min)	80 dB (1 GHz)
Shock Resistance	100 g [ 6 ms]
Vibration	15 g [10 Hz - 2000 Hz]

## Cable fixation

Cable termination protection	Standard back nut (no additional protection)
Fixation type	Cable collet

## Drawings

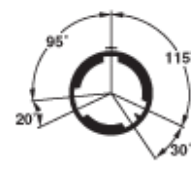
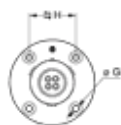

## Dimensions

	A	L	P	M
mm.	38	61	30	10
in.	1.5	2.4	1.18	0.39

## Recommended By Lemo

### Accessories

Replacement contact	<a href="#">FGW.3K.565.ZZC</a>
Compatible cap	<a href="#">BHA.3K.100.EAN</a>

[https://www.lemo.com/int\\_en/solutions/specialties/3k-93c-y-smpte-hybrid/fxw-3k-93c-tlx.html](https://www.lemo.com/int_en/solutions/specialties/3k-93c-y-smpte-hybrid/fxw-3k-93c-tlx.html)

LEMO products and services are provided "as is". LEMO makes no warranties or representations with regard to LEMO product & services or use of them, express, implied or statutory, including for accuracy, completeness, or security. The user is fully responsible for his products and applications using LEMO components.

## Tools

Fiber Tool	<a href="#">WST.KI.125.34</a>
Fiber Tool 2	<a href="#">DCB.91.119.0TN</a>
Positionner	<a href="#">DCE.91.093.BVC</a>
Positionner 2	<a href="#">DCE.91.133.BVCW</a>
Extraction tool	<a href="#">DCC.09.05B.LAG</a>
Extraction tool 2	<a href="#">DCC.13.15B.LAG</a>
Spanner wrench	<a href="#">DCD.3E.ZZZ.PA150</a>

[https://www.lemo.com/int\\_en/solutions/specialties/3k-93c-y-smpte-hybrid/fxw-3k-93c-tlx.html](https://www.lemo.com/int_en/solutions/specialties/3k-93c-y-smpte-hybrid/fxw-3k-93c-tlx.html)

LEMO products and services are provided "as is". LEMO makes no warranties or representations with regard to LEMO product & services or use of them, express, implied or statutory, including for accuracy, completeness, or security. The user is fully responsible for his products and applications using LEMO components.