

Summary

[Request a quote](#)

[Catalog](#)

Number of contacts Low Voltage	72
Wire Size/AWG	28 - 20
Plug	Plug - Fixed
Locking system	Push-pull
Size	6S
Matching parts	PCA.6S.372.CLLC23
Series	S - Indoor Stepped Insert

Technical details

https://www.lemo.com/int_en/solutions/originals/s-indoor-stepped-insert/faa-6s-372-cla.html

LEMO products and services are provided "as is". LEMO makes no warranties or representations with regard to LEMO product & services or use of them, express, implied or statutory, including for accuracy, completeness, or security. The user is fully responsible for his products and applications using LEMO components.

Electrical Configuration

Contact Termination Low voltage	Solder
R (max)	3.6 mOhm
Insert configuration value	6S.372 - 72 Low Voltage
Insulator	L: PEEK (UL 94 / V-0/1.5)
Rated current	4 Amps
Vtest	1200 V (AC), 1800 V (DC)
Contact Type	Solder
Max. Solid Conductor	0.5 mm ² (AWG 20)
Max. Stranded Conductor	0.5 mm ² (AWG 20)
Bucket Dia.	1 mm (0.039in)
Contact Dia.	1.3 mm (0.051in)
Number of contacts Low Voltage	72
Wire Size/AWG	28 - 20

Form & Material

Shell style / Model id	FAA - Fixed plug, non-latching, nut fixing
Plug	Fixed
Housing material	Brass (chrome plated [SAE AMS 2460]) shell and collet nut, nickel plated [SAE AMS QQ N 290] brass latch sleeve and mid pieces
Locking system	Push-pull
Keying	Hermaphroditic keying (half moon insert) with male pin 1
Weight	275.74 g

https://www.lemo.com/int_en/solutions/originals/s-indoor-stepped-insert/faa-6s-372-cla.html

LEMO products and services are provided "as is". LEMO makes no warranties or representations with regard to LEMO product & services or use of them, express, implied or statutory, including for accuracy, completeness, or security. The user is fully responsible for his products and applications using LEMO components.

Environment

Technical domain	Audio Video, Energy and Industrial, Semiconductor, Test and Measurement
Environmental sealing (IP rating)	IP50
Endurance	5000 mating cycles
Temperature range	-55°C / +250°C
Climatical Category	50/175/21
Humidity (max)	<=95% [at 60 deg C /140 F]
Shielding (min)	75 dB (10 MHz)
Shielding (min)	40 dB (1 GHz)
Shock Resistance	100 g [6 ms]
Vibration	15 g [10 Hz - 2000 Hz]
Salt Spray Corrosion	>1000 hr

Drawings

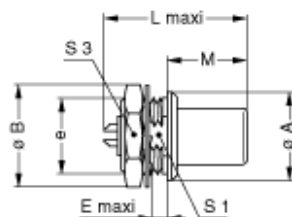
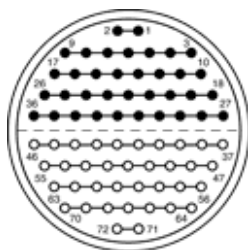

Dimensions

	L	M	A	B	e	E
mm.	45	28	54	54	M48x1.5	2.5
in.	1.77	1.1	2.13	2.13		0.1

https://www.lemo.com/int_en/solutions/originals/s-indoor-stepped-insert/faa-6s-372-cla.html

LEMO products and services are provided "as is". LEMO makes no warranties or representations with regard to LEMO product & services or use of them, express, implied or statutory, including for accuracy, completeness, or security. The user is fully responsible for his products and applications using LEMO components.