



Image for illustrative purpose only

Summary

[Request a quote](#)

[Catalog](#)

Nb of contacts Thermocouple	4
Plug	Plug - Fixed
Locking system	Snap-on
Size	1E
Series	E - Outdoor Stepped Insert

https://www.lemo.com/int_en/solutions/originals/e-outdoor-stepped-insert/faa-1e-902-clk.html

LEMO products and services are provided "as is". LEMO makes no warranties or representations with regard to LEMO product & services or use of them, express, implied or statutory, including for accuracy, completeness, or security. The user is fully responsible for his products and applications using LEMO components.

Technical details

Electrical Configuration

Nb of contacts Thermocouple	4
Contact Termination Thermocouple	Solder
Insert configuration value	1E.902/ThC - 2 Thermocouple Pairs
Insulator	L: PEEK (UL 94 / V-0/1.5)
Rated current	10 A

Form & Material

Shell style / Model id	FAA - Fixed plug, non-latching, nut fixing
Plug	Fixed
Housing material	Brass (chrome plated [SAE AMS 2460]) shell, collet nut and latch sleeve, nickel plated [SAE AMS QQ N 290] brass mid pieces
Locking system	Snap-on
Keying	Hermaphroditic keying (half moon insert) with male pin 1
Colour	Grey
Weight	20.79 g

Environment

Technical domain	Energy and Industrial, Test and Measurement
Environmental sealing (IP rating)	IP68
Endurance	5000 mating cycles
Temperature range	-55°C / +200°C (max. temperature valid for short periods of use.)
Climatical Category	50/175/21
Humidity (max)	<=95% [at 60 deg C /140 F]
Shielding (min)	95 dB (10 MHz)
Shielding (min)	80 dB (1 GHz)
Shock Resistance	100 g [6 ms]
Vibration	15 g [10 Hz - 2000 Hz]
Salt Spray Corrosion	>1000 hr

https://www.lemo.com/int_en/solutions/originals/e-outdoor-stepped-insert/faa-1e-902-clk.html

LEMO products and services are provided "as is". LEMO makes no warranties or representations with regard to LEMO product & services or use of them, express, implied or statutory, including for accuracy, completeness, or security. The user is fully responsible for his products and applications using LEMO components.

Drawings

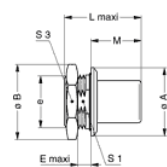
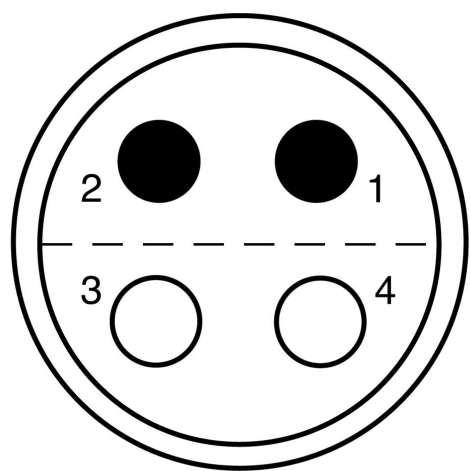

Contact 1, 3: Chromel (+)
Contact 2, 4: Alumel (-)

Dimensions

	A	B	e	E	L	M	S1	S3
mm.	20	21.5	M16x1.0	3.5	23	16	14.5	19
in.	0.79	0.85		0.14	0.91	0.63	0.57	0.75