



*Image for illustrative purpose only*

## Summary

[Request a quote](#)

[Catalog](#)

Number of contacts Low Voltage	2
Wire Size/AWG	26 - 22
Socket / Receptacle	Socket / Receptacle - Fixed Panel Front Mounted
Locking system	Push-pull
Jacket cable outside diameter [mm]	1.00 - 8.30 mm
Size	0S
Suggested matching part	<a href="#">FFA.0S.302.CYBC37</a>
Series	S - Indoor Stepped Insert

[https://www.lemo.com/int\\_en/solutions/originals/s-indoor-stepped-insert/ern-0s-302-cyp.html](https://www.lemo.com/int_en/solutions/originals/s-indoor-stepped-insert/ern-0s-302-cyp.html)

LEMO products and services are provided "as is". LEMO makes no warranties or representations with regard to LEMO product & services or use of them, express, implied or statutory, including for accuracy, completeness, or security. The user is fully responsible for his products and applications using LEMO components.

# Technical details

## Electrical Configuration

Number of contacts Low Voltage	2
Contact Termination Low voltage	Crimp
Insert configuration value	0S.302 - 2 Low Voltage
Insulator	Y: PEEK for crimp contacts
Rated current	10 A
Test voltage (kV DC)	1.6
Contact Dia.	0.9
Wire Size/AWG	26 - 22

## Form & Material

Shell style / Model id	ERN - Fixed receptacle, nut fixing, with grounding tab
Socket / Receptacle	Fixed Panel Front Mounted
Housing material	Brass (chrome plated [SAE AMS 2460]) shell and collet nut, nickel plated [SAE AMS QQ N 290] brass latch sleeve and mid pieces
Locking system	Push-pull
Keying	Hermaphroditic keying (half moon insert) with female pin 1
Colour	Grey
Weight	5.29 g

## Environment

Technical domain	Audio Video, Energy and Industrial, Semiconductor, Test and Measurement
Environmental sealing (IP rating)	IP50
Endurance	5000 mating cycles
Temperature range	-55°C / +250°C (max. temperature valid for short periods of use.)
Climatical Category	50/175/21
Humidity (max)	<=95% [at 60 deg C /140 F]
Shielding (min)	75 dB (10 MHz)
Shielding (min)	40 dB (1 GHz)
Shock Resistance	100 g [ 6 ms]
Vibration	15 g [10 Hz - 2000 Hz]
Salt Spray Corrosion	>1000 hr

[https://www.lemo.com/int\\_en/solutions/originals/s-indoor-stepped-insert/ern-0s-302-cyp.html](https://www.lemo.com/int_en/solutions/originals/s-indoor-stepped-insert/ern-0s-302-cyp.html)

LEMO products and services are provided "as is". LEMO makes no warranties or representations with regard to LEMO product & services or use of them, express, implied or statutory, including for accuracy, completeness, or security. The user is fully responsible for his products and applications using LEMO components.

## Cable fixation

Jacket cable outside diameter [mm]

1.00 - 8.30 mm

## Drawings

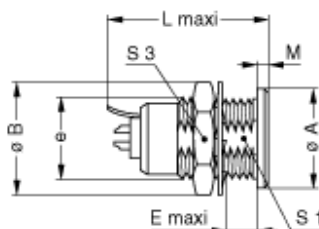

## Dimensions

	A	B	e	E	L	M	S1	S3
mm.	10	12.5	M9x0.6	7	19.3	1.2	8.2	11
in.	0.39	0.49		0.28	0.76	0.05	0.32	0.43

## Recommended By Lemo

### Accessories

Replacement contact

[FGG.0B.561.ZZC](#)

Compatible cap

[BRE.0S.200.NAS](#)

### Tools

Positionner

[DCE.91.090.BVM](#)

Extraction tool

[DCC.09.05B.LAG](#)

Crimp tool

[DPC.91.701.V](#)

Spanner wrench

[Socket for torque wrench DCM.0S.M09.4](#)

[https://www.lemo.com/int\\_en/solutions/originals/s-indoor-stepped-insert/ern-0s-302-cyp.html](https://www.lemo.com/int_en/solutions/originals/s-indoor-stepped-insert/ern-0s-302-cyp.html)

LEMO products and services are provided "as is". LEMO makes no warranties or representations with regard to LEMO product & services or use of them, express, implied or statutory, including for accuracy, completeness, or security. The user is fully responsible for his products and applications using LEMO components.