



Summary

[Request a quote](#)

[Catalog](#)

Number of contacts High Voltage	1
Socket / Receptacle	Socket / Receptacle - Fixed Panel Front Mounted
Locking system	Push-pull
Jacket cable outside diameter [mm]	2.00 - 16.60 mm
Size	3S
Matching parts	FFB.3S.460.CLAC10
Series	S - Indoor Stepped Insert

Technical details

Electrical Configuration

Contact Termination High voltage	Solder
Insert configuration value	3S.460 - 1 High Voltage
Insulator	L: PEEK (UL 94 / V-0/1.5)
Rated current	10 Amps
Test voltage (kV DC)	2.25/7.5
Contact Type	Solder
Air clearance	1.7 mm
Creepage distance	5.5 mm
Number of contacts High Voltage	1

https://www.lemo.com/int_en/solutions/originals/s-indoor-stepped-insert/era-3s-460-cll.html

LEMO products and services are provided "as is". LEMO makes no warranties or representations with regard to LEMO product & services or use of them, express, implied or statutory, including for accuracy, completeness, or security. The user is fully responsible for his products and applications using LEMO components.

Form & Material

Shell style / Model id	ERA - Fixed receptacle, nut fixing
Socket / Receptacle	Fixed Panel Front Mounted
Housing material	Brass (chrome plated [SAE AMS 2460]) shell and collet nut, nickel plated [SAE AMS QQ N 290] brass latch sleeve and mid pieces
Locking system	Push-pull
Keying	Circular, female
Weight	26.4 g

Environment

Technical domain	Audio Video, Energy and Industrial, Semiconductor, Test and Measurement
Environmental sealing (IP rating)	IP50
Endurance	5000 mating cycles
Temperature range	-55°C / +250°C
Climatical Category	50/175/21
Humidity (max)	<=95% [at 60 deg C /140 F]
Shielding (min)	75 dB (10 MHz)
Shielding (min)	40 dB (1 GHz)
Shock Resistance	100 g [6 ms]
Vibration	15 g [10 Hz - 2000 Hz]
Salt Spray Corrosion	>1000 hr

Cable fixation

Jacket cable outside diameter [mm]	2.00 - 16.60 mm
------------------------------------	-----------------

Drawings

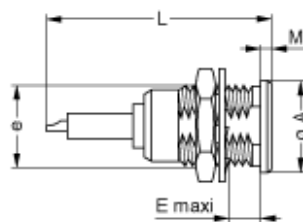
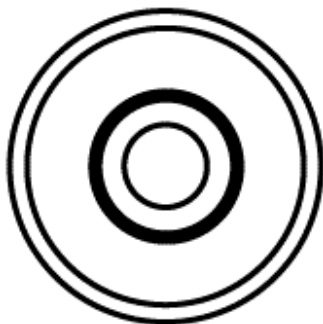

https://www.lemo.com/int_en/solutions/originals/s-indoor-stepped-insert/era-3s-460-cll.html

LEMO products and services are provided "as is". LEMO makes no warranties or representations with regard to LEMO product & services or use of them, express, implied or statutory, including for accuracy, completeness, or security. The user is fully responsible for his products and applications using LEMO components.

Dimensions

	A	e	E	L	M
mm.	22	M18x1.0	11.5	38	2
in.	0.87		0.45	1.5	0.08

https://www.lemo.com/int_en/solutions/originals/s-indoor-stepped-insert/era-3s-460-cll.html

LEMO products and services are provided "as is". LEMO makes no warranties or representations with regard to LEMO product & services or use of them, express, implied or statutory, including for accuracy, completeness, or security. The user is fully responsible for his products and applications using LEMO components.