



*Image for illustrative purpose only*

## Summary

[Request a quote](#)

[Catalog](#)

Number of contacts High Voltage	1
Wire Size/AWG	22 - 14
Socket / Receptacle	Socket / Receptacle - Fixed Panel Front Mounted
Locking system	Push-pull
Jacket cable outside diameter [mm]	1.00 - 13.60 mm
Size	2S
Suggested matching part	<a href="#">FFB.2S.408.CLAC72</a>
Series	S - Indoor Stepped Insert

[https://www.lemo.com/int\\_en/solutions/originals/s-indoor-stepped-insert/era-2s-408-cll.html](https://www.lemo.com/int_en/solutions/originals/s-indoor-stepped-insert/era-2s-408-cll.html)

LEMO products and services are provided "as is". LEMO makes no warranties or representations with regard to LEMO product & services or use of them, express, implied or statutory, including for accuracy, completeness, or security. The user is fully responsible for his products and applications using LEMO components.

# Technical details

## Electrical Configuration

Number of contacts High Voltage	1
Contact Termination High voltage	Solder
Insert configuration value	2S.408 - 1 High Voltage
Insulator	L: PEEK (UL 94 / V-0/1.5)
Rated current	10 A
Test voltage (kV DC)	12
Air clearance	11.5 mm
Creepage distance	11.9 mm
Contact Dia.	2
Wire Size/AWG	22 - 14

## Form & Material

Shell style / Model id	ERA - Fixed receptacle, nut fixing
Socket / Receptacle	Fixed Panel Front Mounted
Housing material	Brass (chrome plated [SAE AMS 2460]) shell and collet nut, nickel plated [SAE AMS QQ N 290] brass latch sleeve and mid pieces
Locking system	Push-pull
Keying	Circular, female
Colour	Grey
Weight	14.88 g

[https://www.lemo.com/int\\_en/solutions/originals/s-indoor-stepped-insert/era-2s-408-cll.html](https://www.lemo.com/int_en/solutions/originals/s-indoor-stepped-insert/era-2s-408-cll.html)

LEMO products and services are provided "as is". LEMO makes no warranties or representations with regard to LEMO product & services or use of them, express, implied or statutory, including for accuracy, completeness, or security. The user is fully responsible for his products and applications using LEMO components.

## Environment

Technical domain	Audio Video, Energy and Industrial, Semiconductor, Test and Measurement
Environmental sealing (IP rating)	IP50
Endurance	5000 mating cycles
Temperature range	-55°C / +250°C (max. temperature valid for short periods of use.)
Climatical Category	50/175/21
Humidity (max)	<=95% [at 60 deg C /140 F]
Shielding (min)	75 dB (10 MHz)
Shielding (min)	40 dB (1 GHz)
Shock Resistance	100 g [ 6 ms]
Vibration	15 g [10 Hz - 2000 Hz]
Salt Spray Corrosion	>1000 hr

## Cable fixation

Jacket cable outside diameter [mm]	1.00 - 13.60 mm
------------------------------------	-----------------

## Drawings

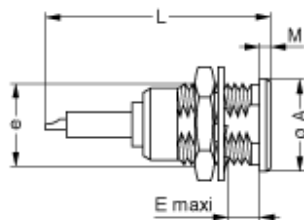

## Dimensions

	A	E	L	M	e
mm.	18	8.3	41.5	1.8	M15x1.0
in.	0.71	0.33	1.63	0.07	

[https://www.lemo.com/int\\_en/solutions/originals/s-indoor-stepped-insert/era-2s-408-cll.html](https://www.lemo.com/int_en/solutions/originals/s-indoor-stepped-insert/era-2s-408-cll.html)

LEMO products and services are provided "as is". LEMO makes no warranties or representations with regard to LEMO product & services or use of them, express, implied or statutory, including for accuracy, completeness, or security. The user is fully responsible for his products and applications using LEMO components.

# Recommended By Lemo

## Accessories

---

Compatible cap

[BRE.2S.200.NAS](#)

[https://www.lemo.com/int\\_en/solutions/originals/s-indoor-stepped-insert/era-2s-408-cll.html](https://www.lemo.com/int_en/solutions/originals/s-indoor-stepped-insert/era-2s-408-cll.html)

LEMO products and services are provided “as is”. LEMO makes no warranties or representations with regard to LEMO product & services or use of them, express, implied or statutory, including for accuracy, completeness, or security. The user is fully responsible for his products and applications using LEMO components.