



*Image for illustrative purpose only*

## Summary

[Request a quote](#)

[Catalog](#)

Number of contacts Low Voltage	6
Wire Size/AWG	28 - 20
Socket / Receptacle	Socket / Receptacle - Fixed Panel Front Mounted
Locking system	Push-pull
Size	SH
Suggested matching part	<a href="#">FHA.SH.306.XLAC72N</a>

[https://www.lemo.com/int\\_en/eha-sh-306-xll.html](https://www.lemo.com/int_en/eha-sh-306-xll.html)

LEMO products and services are provided "as is". LEMO makes no warranties or representations with regard to LEMO product & services or use of them, express, implied or statutory, including for accuracy, completeness, or security. The user is fully responsible for his products and applications using LEMO components.

# Technical details

## Electrical Configuration

Contact Termination Low voltage	Solder
Insert configuration value	SH.306 - 6 Low Voltage
Contact Type	Solder
Contact Dia.	1.3
Number of contacts Low Voltage	6
Wire Size/AWG	28 - 20

## Form & Material

Shell style / Model id	EHA - Fixed receptacle, nut fixing (IP50)
Socket / Receptacle	Fixed Panel Front Mounted
Housing material	Aluminium (nickel plated [SAE AMS QQ N 290], anthracite color) shell and nut, other pieces bronze/brass
Locking system	Push-pull
Keying	Hermaphroditic keying (half moon insert) with female pin 1
Weight	20.02 g

## Environment

Environmental sealing (IP rating)	IP50
Salt Spray Corrosion	max. 48 hr

## Drawings

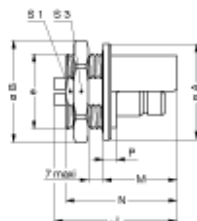

## Dimensions

	A	B	e	Loptic	Lelect	M	N	P	S1	S3
mm.	27	28.5	M22x1	38.8	30.5	19.5	30.5	3.3	20.5	25
in.	1.06	1.12		1.53	1.2	0.77	1.2	0.13	0.81	0.98

[https://www.lemo.com/int\\_en/eha-sh-306-xll.html](https://www.lemo.com/int_en/eha-sh-306-xll.html)

LEMO products and services are provided "as is". LEMO makes no warranties or representations with regard to LEMO product & services or use of them, express, implied or statutory, including for accuracy, completeness, or security. The user is fully responsible for his products and applications using LEMO components.