



Image for illustrative purpose only

Summary

[Request a quote](#)

[Catalog](#)

Nb of contacts Fiber optic	4
Socket / Receptacle	Socket / Receptacle - Fixed Panel Front Mounted
Locking system	Push-pull
Size	SH

https://www.lemo.com/int_en/eha-sh-03c-xlz.html

LEMO products and services are provided "as is". LEMO makes no warranties or representations with regard to LEMO product & services or use of them, express, implied or statutory, including for accuracy, completeness, or security. The user is fully responsible for his products and applications using LEMO components.

Technical details

Electrical Configuration

Nb of contacts Fiber optic	4
Insert configuration value	SH.03C - 4 FO TYPE F7

Form & Material

Shell style / Model id	EHA - Fixed receptacle, nut fixing (IP50)
Socket / Receptacle	Fixed Panel Front Mounted
Housing material	Aluminium (nickel plated [SAE AMS QQ N 290], anthracite color) shell and nut, other pieces bronze/brass
Locking system	Push-pull
Keying	Hermaphroditic keying (half moon insert) with female pin 1
Weight	21.79 g

Environment

Environmental sealing (IP rating)	IP50
Salt Spray Corrosion	max. 48 hr

Drawings

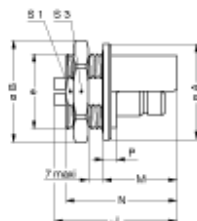

Dimensions

	A	B	e	Loptic	Lelect	M	N	P	S1	S3
mm.	27	28.5	M22x1	38.8	30.5	19.5	30.5	3.3	20.5	25
in.	1.06	1.12		1.53	1.2	0.77	1.2	0.13	0.81	0.98

https://www.lemo.com/int_en/eha-sh-03c-xlz.html

LEMO products and services are provided "as is". LEMO makes no warranties or representations with regard to LEMO product & services or use of them, express, implied or statutory, including for accuracy, completeness, or security. The user is fully responsible for his products and applications using LEMO components.