



## Summary

[Request a quote](#)

[Catalog](#)

Coax	4
Low Voltage	38
Socket / Receptacle	Socket / Receptacle - Fixed Panel Front Mounted
Locking system	Push-pull
Jacket cable outside diameter [mm]	13.00 - 52.10 mm
Size	6E
Matching parts	<a href="#">FGG.6E.884.CLAC215</a>
Series	E - Outdoor Stepped Insert

## Technical details

### Electrical Configuration

Contact Termination Low voltage	Solder
Coax	4
Insulator	L: PEEK (UL 94 / V-0/1.5)
Cable type	Cable type: A RG 59 B/U, RG 302 /U, RG 400 /U S
Low Voltage	38

[https://www.lemo.com/int\\_en/solutions/originals/e-outdoor-stepped-insert/egg-6e-884-cll5.html](https://www.lemo.com/int_en/solutions/originals/e-outdoor-stepped-insert/egg-6e-884-cll5.html)

LEMO products and services are provided "as is". LEMO makes no warranties or representations with regard to LEMO product & services or use of them, express, implied or statutory, including for accuracy, completeness, or security. The user is fully responsible for his products and applications using LEMO components.

## Form & Material

Shell style / Model id	EG - Fixed receptacle, nut fixing
Socket / Receptacle	Fixed Panel Front Mounted
Housing material	Brass (chrome plated [SAE AMS 2460]) shell, collet nut and latch sleeve, nickel plated [SAE AMS QQ N 290] brass mid pieces
Locking system	Push-pull
Keying	Hermaphroditic keying (half moon insert) with female pin 1
Weight	401.15 g

## Environment

Technical domain	Energy and Industrial, Test and Measurement
Environmental protection (IP rating)	IP68
Minimal temperature	-55°C / +200°C
Climatical Category	50/175/21
Humidity (max)	<=95% [at 60 deg C /140 F]
Shielding (min)	95 dB (10 MHz)
Shielding (min)	80 dB (1 GHz)
Shock Resistance	100 g [ 6 ms]
Vibration	15 g [10 Hz - 2000 Hz]
Salt Spray Corrosion	>1000 hr

## Cable fixation

Jacket cable outside diameter [mm]	13.00 - 52.10 mm
------------------------------------	------------------

## Drawings

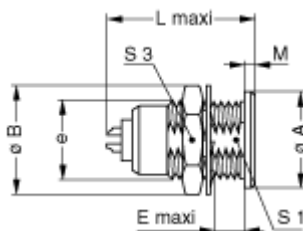

[https://www.lemo.com/int\\_en/solutions/originals/e-outdoor-stepped-insert/egg-6e-884-cll5.html](https://www.lemo.com/int_en/solutions/originals/e-outdoor-stepped-insert/egg-6e-884-cll5.html)

LEMO products and services are provided "as is". LEMO makes no warranties or representations with regard to LEMO product & services or use of them, express, implied or statutory, including for accuracy, completeness, or security. The user is fully responsible for his products and applications using LEMO components.

## Dimensions

	<b>A</b>	<b>B</b>	<b>e</b>	<b>E</b>	<b>L</b>	<b>M</b>	<b>S1</b>
mm.	65	65	M55x2.0	10	48.5	10	52
in.	2.56	2.56		0.39	1.91	0.39	2.05

[https://www.lemo.com/int\\_en/solutions/originals/e-outdoor-stepped-insert/egg-6e-884-cll5.html](https://www.lemo.com/int_en/solutions/originals/e-outdoor-stepped-insert/egg-6e-884-cll5.html)

LEMO products and services are provided "as is". LEMO makes no warranties or representations with regard to LEMO product & services or use of them, express, implied or statutory, including for accuracy, completeness, or security. The user is fully responsible for his products and applications using LEMO components.