



*Image for illustrative purpose only*

## Summary

[Request a quote](#)

[Catalog](#)

Number of contacts Low Voltage	10
Wire Size/AWG	14 - 10
Socket / Receptacle	Socket / Receptacle - Fixed Panel Front Mounted
Locking system	Push-pull
Size	5N
Series	N - Nuclear Stainless Steel

[https://www.lemo.com/int\\_en/solutions/supreme/n-nuclear-stainless-steel/edg-5n-310-tlc.html](https://www.lemo.com/int_en/solutions/supreme/n-nuclear-stainless-steel/edg-5n-310-tlc.html)

LEMO products and services are provided "as is". LEMO makes no warranties or representations with regard to LEMO product & services or use of them, express, implied or statutory, including for accuracy, completeness, or security. The user is fully responsible for his products and applications using LEMO components.

# Technical details

## Electrical Configuration

Number of contacts Low Voltage	10
Contact Termination Low voltage	Crimp
R (max)	3.1 mOhm
Insert configuration value	5N.310 - 10 Low Voltage
Insulator	L: PEEK (UL 94 / V-0/1.5)
Rated current	20 A
Contact retention	75 N
Max. Conductor	4 mm <sup>2</sup> (AWG 10)
Min. Conductor	2.5 mm <sup>2</sup> (AWG 14)
Bucket Dia.	2.9 mm (0.114in)
Contact Dia.	3 mm (0.118in)
Wire Size/AWG	14 - 10

## Form & Material

Shell style / Model id	EDG - Fixed receptacle with square flange, 4 screw fixing, with long pre-positioning sleeve
Socket / Receptacle	Fixed Panel Front Mounted
Housing material	Stainless steel shell, collet nut and latch sleeve, nickel plated [SAE AMS QQ N 290] brass mid pieces
Locking system	Push-pull
Keying	Push-Pull latch for manipulator. Male contacts
Colour	Grey
Weight	692.95 g

## Environment

Technical domain	Energy and Industrial, Specialties and Other
Environmental sealing (IP rating)	IP66

# Drawings

[https://www.lemo.com/int\\_en/solutions/supreme/n-nuclear-stainless-steel/edg-5n-310-tlc.html](https://www.lemo.com/int_en/solutions/supreme/n-nuclear-stainless-steel/edg-5n-310-tlc.html)

LEMO products and services are provided "as is". LEMO makes no warranties or representations with regard to LEMO product & services or use of them, express, implied or statutory, including for accuracy, completeness, or security. The user is fully responsible for his products and applications using LEMO components.

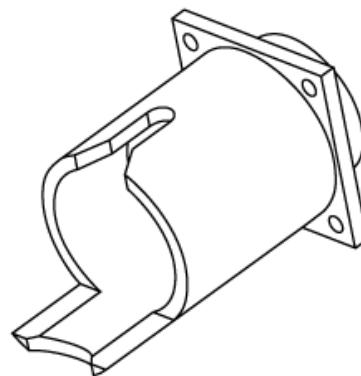
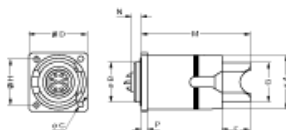

## Dimensions

	A	B	C	D	F	G	H	M	N	P
mm.	55	45	5.2	58	28.0	35	46	94.0	13.2	5
in.	2.17	1.77	0.2	2.28	1.1	1.38	1.81	3.7	0.52	0.2

## Recommended By Lemo

### Accessories

Replacement contact [FGG.5B.580.ZZC](#)

### Tools















Positionner [DCE.91.305.BVCM](#)

Extraction tool [DCC.30.35B.LAG](#)

[https://www.lemo.com/int\\_en/solutions/supreme/n-nuclear-stainless-steel/edg-5n-310-tlc.html](https://www.lemo.com/int_en/solutions/supreme/n-nuclear-stainless-steel/edg-5n-310-tlc.html)

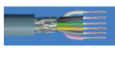
LEMO products and services are provided "as is". LEMO makes no warranties or representations with regard to LEMO product & services or use of them, express, implied or statutory, including for accuracy, completeness, or security. The user is fully responsible for his products and applications using LEMO components.

# Cables

Cable PartNumber	Material	Colour	Cable image
CMN.10.T20.080PGZE		grey	
CMN.10.T20.080PNZE			
CMN.10.T20.080QGC	TPR	Grey	
CMN.10.T22.068QGZE	TPR (medical)	Grey	
CMN.10.T28.052PGZE		grey	
CMN.10.T28.052PNZE			
CMN.10.T28.053QGZE	TPR (medical)	Grey	
110220	PVC	Black	
110240	PTFE	White	
110260	PTFE	White	
110280	PVC	Black	
210140	PVC	Grey	
210240	PVC	Black	
210250	PVC	Grey	
210260	PVC	Black	

[https://www.lemo.com/int\\_en/solutions/supreme/n-nuclear-stainless-steel/edg-5n-310-tlc.html](https://www.lemo.com/int_en/solutions/supreme/n-nuclear-stainless-steel/edg-5n-310-tlc.html)

LEMO products and services are provided "as is". LEMO makes no warranties or representations with regard to LEMO product & services or use of them, express, implied or statutory, including for accuracy, completeness, or security. The user is fully responsible for his products and applications using LEMO components.