



Image for illustrative purpose only

Summary

[Request a quote](#)

[Catalog](#)

Number of contacts Low Voltage	10
Wire Size/AWG	18 - 14
Socket / Receptacle	Socket / Receptacle - Fixed Panel Front Mounted
Locking system	Push-pull
Size	4N
Series	N - Nuclear Stainless Steel

https://www.lemo.com/int_en/solutions/supreme/n-nuclear-stainless-steel/edg-4n-310-tyc.html

LEMO products and services are provided "as is". LEMO makes no warranties or representations with regard to LEMO product & services or use of them, express, implied or statutory, including for accuracy, completeness, or security. The user is fully responsible for his products and applications using LEMO components.

Technical details

Electrical Configuration

Contact Termination Low voltage	Crimp
R (max)	3.5 mOhm
Insert configuration value	4N.310 - 10 Low Voltage
Insulator	Y: PEEK
Rated current	17 A
Contact retention	50 N
Contact Type	Crimp
Max. Conductor	1.5 mm ² (AWG 14)
Min. Conductor	1 mm ² (AWG 18)
Bucket Dia.	1.9 mm (0.075in)
Contact Dia.	1.6 mm (0.063in)
Number of contacts Low Voltage	10
Wire Size/AWG	18 - 14

Form & Material

Shell style / Model id	EDG - Fixed receptacle with square flange, 4 screw fixing, with long pre-positioning sleeve
Socket / Receptacle	Fixed Panel Front Mounted
Housing material	Stainless steel shell, collet nut and latch sleeve, nickel plated [SAE AMS QQ N 290] brass mid pieces
Locking system	Push-pull
Keying	Push-Pull latch for manipulator. Male contacts
Colour	Grey
Weight	325.29 g

Environment

Technical domain	Energy and Industrial, Specialties and Other
Environmental sealing (IP rating)	IP66

https://www.lemo.com/int_en/solutions/supreme/n-nuclear-stainless-steel/edg-4n-310-tyc.html

LEMO products and services are provided "as is". LEMO makes no warranties or representations with regard to LEMO product & services or use of them, express, implied or statutory, including for accuracy, completeness, or security. The user is fully responsible for his products and applications using LEMO components.

Drawings

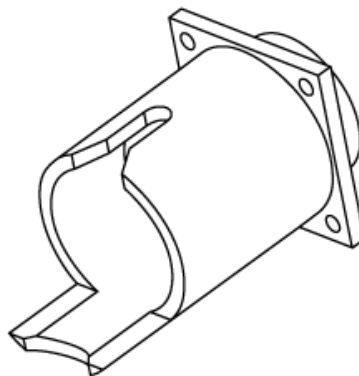
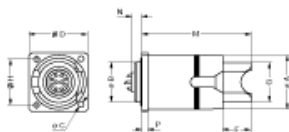

Dimensions

	A	B	C	D	F	G	H	M	N	P
mm.	40	30	4.2	43	20.0	24	35	74.0	10.7	4
in.	1.57	1.18	0.17	1.69	0.79	0.94	1.38	2.91	0.42	0.16

Recommended By Lemo

Accessories

Replacement contact

[FGG.4B.570.ZZC](#)

Tools









Extraction tool

[DCC.16.25B.LAG](#)

https://www.lemo.com/int_en/solutions/supreme/n-nuclear-stainless-steel/edg-4n-310-tyc.html

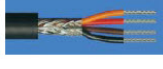
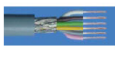
LEMO products and services are provided "as is". LEMO makes no warranties or representations with regard to LEMO product & services or use of them, express, implied or statutory, including for accuracy, completeness, or security. The user is fully responsible for his products and applications using LEMO components.

Cables

Cable PartNumber	Material	Colour	Cable image
CMN.10.T20.080PGZE		grey	
CMN.10.T20.080PNZE			
CMN.10.T20.080QGC	TPR	Grey	
CMN.10.T22.068QGZE	TPR (medical)	Grey	
CMN.10.T28.052PGZE		grey	
CMN.10.T28.052PNZE			
CMN.10.T28.053QGZE	TPR (medical)	Grey	
110220	PVC	Black	
110240	PTFE	White	
110260	PTFE	White	
110280	PVC	Black	
210140	PVC	Grey	
210240	PVC	Black	
210250	PVC	Grey	
210260	PVC	Black	

https://www.lemo.com/int_en/solutions/supreme/n-nuclear-stainless-steel/edg-4n-310-tyc.html

LEMO products and services are provided "as is". LEMO makes no warranties or representations with regard to LEMO product & services or use of them, express, implied or statutory, including for accuracy, completeness, or security. The user is fully responsible for his products and applications using LEMO components.