



*Image for illustrative purpose only*

## Summary

[Request a quote](#)

[Catalog](#)

Nb of contacts Coax	1
Socket / Receptacle	Socket / Receptacle - Fixed Panel Rear Mounted
Locking system	Push-pull
Size	1
Suggested matching part	<a href="#">FFS.01.250.DLAE31</a>

[https://www.lemo.com/int\\_en/ecp-01-250-dll.html](https://www.lemo.com/int_en/ecp-01-250-dll.html)

LEMO products and services are provided "as is". LEMO makes no warranties or representations with regard to LEMO product & services or use of them, express, implied or statutory, including for accuracy, completeness, or security. The user is fully responsible for his products and applications using LEMO components.

# Technical details

## Electrical Configuration

Nb of contacts Coax	1
Contact Termination Coax - Conductor fixing	Solder
Insert configuration value	1.25 - 1 Coax (50 Ohm)
Rated current	4 A
OHM	50

## Form & Material

Shell style / Model id	ECP.01 - Fixed receptacle, nut fixing (back panel mounting)
Socket / Receptacle	Fixed Panel Rear Mounted
Housing material	Brass (gold plated [ISO 27874]) shell, collet nut, brass latch sleeve and mid pieces
Locking system	Push-pull
Keying	Circular, female
Weight	1.06 g

## Environment

Environmental sealing (IP rating)	IP50
Endurance	1000 mating cycles
Temperature range	-55°C / +230°C (max. temperature valid for short periods of use.)

# Drawings

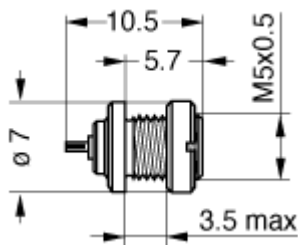

## Dimensions

	A	e	L	M	E <sub>max</sub>
mm.	7	M5x0.5	10.5	5.7	3.5
in.	0.28		0.41	0.22	0.14

[https://www.lemo.com/int\\_en/ecp-01-250-dll.html](https://www.lemo.com/int_en/ecp-01-250-dll.html)

LEMO products and services are provided "as is". LEMO makes no warranties or representations with regard to LEMO product & services or use of them, express, implied or statutory, including for accuracy, completeness, or security. The user is fully responsible for his products and applications using LEMO components.