



Image for illustrative purpose only

Summary

[Request a quote](#)

[Catalog](#)

Number of contacts Low Voltage	19
Wire Size/AWG	30 - 22
Gender	Standard
Socket / Receptacle	Socket / Receptacle - Fixed Panel Rear Mounted
Locking system	Push-pull
Size	2P
Suggested matching part	CAB.M19.GYC.C52A
Series	REDEL P - Push-Pull

https://www.lemo.com/int_en/solutions/redel/redel-p-push-pull/ckb-m19-gyma.html

LEMO products and services are provided "as is". LEMO makes no warranties or representations with regard to LEMO product & services or use of them, express, implied or statutory, including for accuracy, completeness, or security. The user is fully responsible for his products and applications using LEMO components.

Technical details

Electrical Configuration

Number of contacts Low Voltage	19
Contact Termination Low voltage	Crimp
Insert configuration value	2P.M19 - 19 Low V.
Insulator	Y: PEEK for crimp contacts
Rated current	4.5 A
Test voltage contact-contact	1.48 (kV DC)
Air clearance	0.6 mm
Creepage distance	0.6 mm
Bucket Dia.	0.8
Contact Dia.	0.7
Wire Size/AWG	30 - 22
Gender	Standard

Form & Material

Shell style / Model id	CK - Fixed receptacle with two nuts (back panel mounting)
Socket / Receptacle	Fixed Panel Rear Mounted
Housing material	PSU (Polysulfone), grey
Locking system	Push-pull
Keying	B: 3 keys (alpha=0, gamma=60, Plug: male contacts, Receptacle: female contacts)
Colour	Grey
Variant	Blue front flange
Weight	7.23 g

https://www.lemo.com/int_en/solutions/redel/redel-p-push-pull/ckb-m19-gyma.html

LEMO products and services are provided "as is". LEMO makes no warranties or representations with regard to LEMO product & services or use of them, express, implied or statutory, including for accuracy, completeness, or security. The user is fully responsible for his products and applications using LEMO components.

Environment

Technical domain	Energy and Industrial, Medical, Test and Measurement, Transportation, Aerospace and UAV
Environmental sealing (IP rating)	IP50
Endurance	>5000 mating cycles
Temperature range	-50°C / +150°C
F ret (max)	250 N
F ret (min)	150 N
Steam sterilization	Fully sterilizable (Steam, Gamma, ETO) following our protocols and tests in line with ISO 11134 and IEC 60601-1 standards. For more details on sterilization methods and cycles, please contact us.

Cable fixation

Cable termination protection	Standard back nut (no additional protection)
Fixation type	Cable collet

Drawings

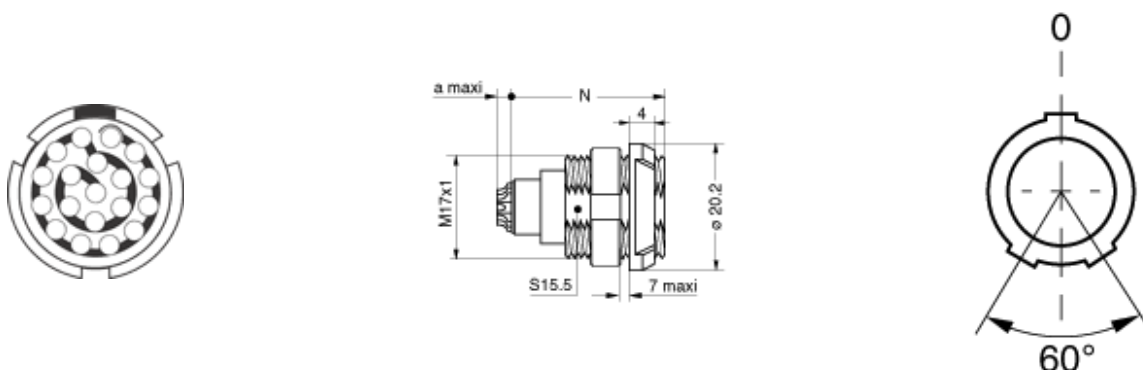

Dimensions

	N
mm.	25.1
in.	0.99

https://www.lemo.com/int_en/solutions/redel/redel-p-push-pull/ckb-m19-gyma.html

LEMO products and services are provided "as is". LEMO makes no warranties or representations with regard to LEMO product & services or use of them, express, implied or statutory, including for accuracy, completeness, or security. The user is fully responsible for his products and applications using LEMO components.

Recommended By Lemo

Accessories	
Replacement contact	EGG.2B.655.ZZM
Tools	
Spanner	COP.155.GN
Positionner	DCE.91.072.BVM
Extraction tool	DCC.07.04B.LAG
Crimp tool	DPC.91.701.V