



*Image for illustrative purpose only*

## Summary

[Request a quote](#)

[Catalog](#)

|                                |  |
|--------------------------------|--|
| Number of contacts Low Voltage | 16   |
| Wire Size/AWG                  | 30 - 22  |
| Gender                         | Standard                                       |
| Socket / Receptacle            | Socket / Receptacle - Fixed Panel Rear Mounted |
| Locking system                 | Push-pull                                      |
| Size                           | 2P   |
| Suggested matching part        | <a href="#">CAB.M16.GYZ.C72G</a>               |
| Series                         | REDEL P - Push-Pull                            |

[https://www.lemo.com/int\\_en/solutions/redel/redel-p-push-pull/ckb-m16-gymg.html](https://www.lemo.com/int_en/solutions/redel/redel-p-push-pull/ckb-m16-gymg.html)

LEMO products and services are provided "as is". LEMO makes no warranties or representations with regard to LEMO product & services or use of them, express, implied or statutory, including for accuracy, completeness, or security. The user is fully responsible for his products and applications using LEMO components.

# Technical details

## Electrical Configuration

|                                 |                            |
|---------------------------------|----------------------------|
| Number of contacts Low Voltage  | 16                         |
| Contact Termination Low voltage | Crimp                      |
| Insert configuration value      | 2P.M16 - 16 Low V.         |
| Insulator                       | Y: PEEK for crimp contacts |
| Rated current                   | 5 A                        |
| Test voltage contact-contact    | 1.63 (kV DC)               |
| Air clearance                   | 0.65 mm                    |
| Creepage distance               | 0.65 mm                    |
| Bucket Dia.                     | 0.8                        |
| Contact Dia.                    | 0.7                        |
| Wire Size/AWG                   | 30 - 22                    |
| Gender                          | Standard                   |

## Form & Material

|                        |   |
|------------------------|---|
| Shell style / Model id | CK - Fixed receptacle with two nuts (back panel mounting)                       |
| Socket / Receptacle    | Fixed Panel Rear Mounted  |
| Housing material       | PSU (Polysulfone), grey   |
| Locking system         | Push-pull   |
| Keying                 | B: 3 keys (alpha=0, gamma=60, Plug: male contacts, Receptacle: female contacts) |
| Colour                 | Grey  |
| Weight                 | 7.01 g  |

[https://www.lemo.com/int\\_en/solutions/redel/redel-p-push-pull/ckb-m16-gymg.html](https://www.lemo.com/int_en/solutions/redel/redel-p-push-pull/ckb-m16-gymg.html)

LEMO products and services are provided "as is". LEMO makes no warranties or representations with regard to LEMO product & services or use of them, express, implied or statutory, including for accuracy, completeness, or security. The user is fully responsible for his products and applications using LEMO components.

## Environment

|                                   |   |
|-----------------------------------|---|
| Technical domain                  | Energy and Industrial, Medical, Test and Measurement, Transportation, Aerospace and UAV   |
| Environmental sealing (IP rating) | IP50  |
| Endurance                         | >5000 mating cycles   |
| Temperature range                 | -50°C / +150°C  |
| F ret (max)                       | 250 N   |
| F ret (min)                       | 150 N   |
| Steam sterilization               | Fully sterilizable (Steam, Gamma, ETO) following our protocols and tests in line with ISO 11134 and IEC 60601-1 standards. For more details on sterilization methods and cycles, please contact us. |

## Cable fixation

|                              |  |
|------------------------------|--|
| Cable termination protection | Standard back nut (no additional protection) |
| Fixation type                | Cable collet                                 |

# Drawings

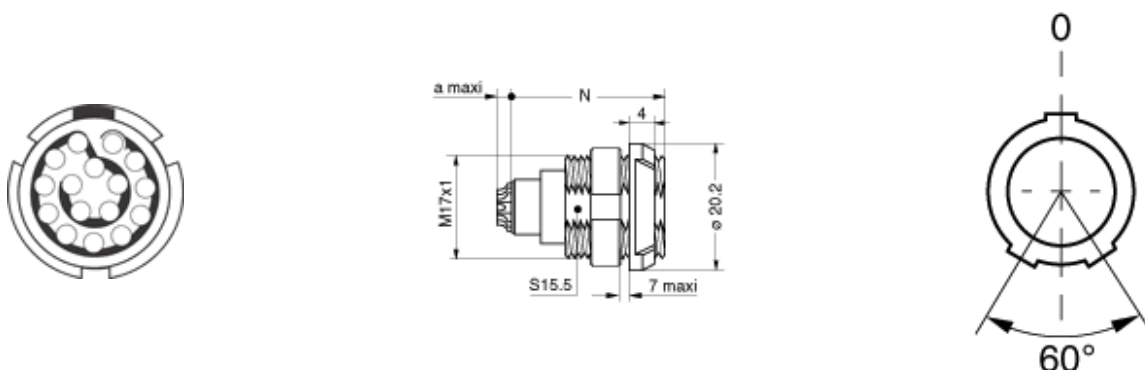

## Dimensions

|     | N    |
|-----|------|
| mm. | 25.1 |
| in. | 0.99 |

[https://www.lemo.com/int\\_en/solutions/redel/redel-p-push-pull/ckb-m16-gymg.html](https://www.lemo.com/int_en/solutions/redel/redel-p-push-pull/ckb-m16-gymg.html)

LEMO products and services are provided "as is". LEMO makes no warranties or representations with regard to LEMO product & services or use of them, express, implied or statutory, including for accuracy, completeness, or security. The user is fully responsible for his products and applications using LEMO components.

# Recommended By Lemo

| Accessories         |                                |
|---------------------|--------------------------------|
| Replacement contact | <a href="#">EGG.2B.655.ZZM</a> |
| Tools               |                                |
| Spanner             | <a href="#">COP.155.GN</a>     |
| Positionner         | <a href="#">DCE.91.072.BVM</a> |
| Extraction tool     | <a href="#">DCC.07.04B.LAG</a> |
| Crimp tool          | <a href="#">DPC.91.701.V</a>   |