

M SERIES USB CONNECTORS RATCHET COUPLING



Rugged waterproof USB connector (IP68)

A USB connector is added to LEMO's M series range. M series USB type A connector offers a reliable solution for harsh environment. The interface meets IP 68 when mated.

The complete product line includes panel mount sockets, plugs, protective cap and also MIL spec adaptor backshell.

Benefits

- Lightweight
- Dark finish
- Rugged

The connector is designed for outdoor use, for factory automation, oil/petroleum industries, heavy duty, railways, automotive, military, any market that requires rugged and reliable connection.

Features

- IP 68
- Aluminium outershell with nickel anthracite finish
- Optional threaded backend for MIL DTL-38999L backshell
- USB 2.0

Interconnections

USB models

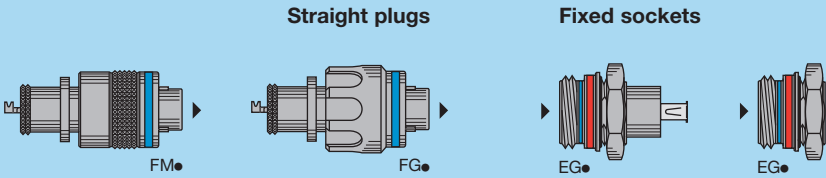

Alignment Key and Polarized Keying System

Front view of a socket 	Model	Nb of keys	Angles				Colour code	Contact type	
			α	β	γ	δ		Plug	Socket
			●●W	5	95°	115°		35°	25°
●●R	105°	115°	30°		20°	yellow			

Models

FM•LM.U2A.XPAT

**Straight plug, key (W) or key (R)
with knurled grip and mold stop**

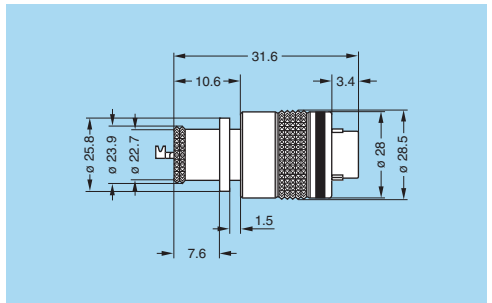

FG•LM.U2A.XPAT

**Straight plug, key (W) or key (R)
with arctic grip and mold stop**

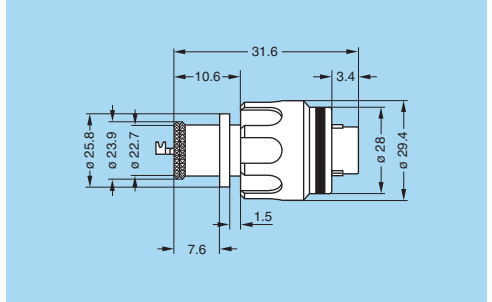

EG•LM.U2A.XPP

**Fixed socket, female to female, nut fixing,
key (W) or key (R)**

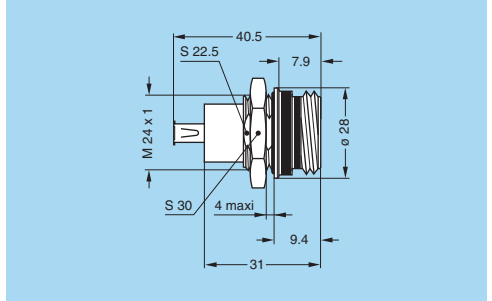

EG•LM.U2A.XPL

**Fixed socket, nut fixing,
key (W) or key (R)**

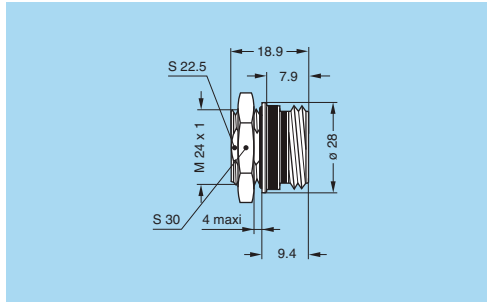

Insert configuration

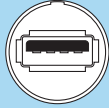
Male front view	Female front view	Reference	Number of contacts	Solder contact	AWG	Test voltage (kV rms) ¹⁾ Contact-contact	Test voltage (kV rms) ¹⁾ Contact-shell	Rated current (A) ¹⁾
		U2A	4	●	–	1.20	0.95	n.a.

Note: ¹⁾ Test voltage according to IEC 60512-2 test 4a.

Cut-outs

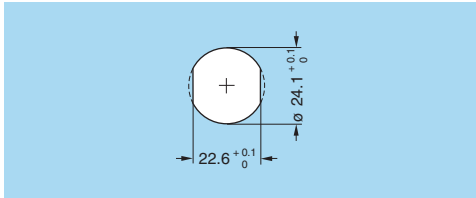

Mounting nut torque (on panel)

Torque (Nm)
6.5

LEMO HEADQUARTERS

Ch. des Champs-Courbes 28
P.O. Box 194, CH-1024 Ecublens
Tel: (+41 21) 695 16 00
Fax: (+41 21) 695 16 02
info@lemo.com