



Image for illustrative purpose only

概要

見積もりを依頼する

[REDEL T7 en](#)

Nb of contacts Triax	1
Socket / Receptacle	Socket / Receptacle - Fixed Panel Front Mounted
Locking system	Push-pull
Panel Drill Hole	M25
Size	T7
推奨適合部品	FAZ.T7.675.CTA06S

https://www.lemo.com/int_jp/psz-t7-675-ctl06s.html

LEMO products and services are provided "as is". LEMO makes no warranties or representations with regard to LEMO product & services or use of them, express, implied or statutory, including for accuracy, completeness, or security. The user is fully responsible for his products and applications using LEMO components.

Technical details

Electrical Configuration

Nb of contacts Triax	1
Contact Termination Triax	Solder
Rated current	12 A
Impedance	75 Ohms

Form & Material

Shell style / Model id	PSZ - Fixed socket, crimp, nut fixing
Socket / Receptacle	Fixed Panel Front Mounted
Housing material	Brass (chrome plated [SAE AMS 2460]) shell and collet nut, nickel plated [SAE AMS QQ N 290] brass latch sleeve and mid pieces
Locking system	Push-pull
Keying	Circular, female
Colour	Grey
Panel Drill Hole	M25

Environment

Environmental sealing (IP rating)	IP68
Endurance	5000 mating cycles
Temperature range	-55°C / +250°C (max. temperature valid for short periods of use.)
Humidity (max)	<=95% [at 60 deg C /140 F]
Shock Resistance	100 g [6 ms]
Vibration	15 g [10 Hz - 20000 Hz]
Salt Spray Corrosion	>1000 hr

Cable fixation

Cable termination protection	Standard back nut (no additional protection)
------------------------------	--



https://www.lemo.com/int_jp/psz-t7-675-ctl06s.html

LEMO products and services are provided "as is". LEMO makes no warranties or representations with regard to LEMO product & services or use of them, express, implied or statutory, including for accuracy, completeness, or security. The user is fully responsible for his products and applications using LEMO components.

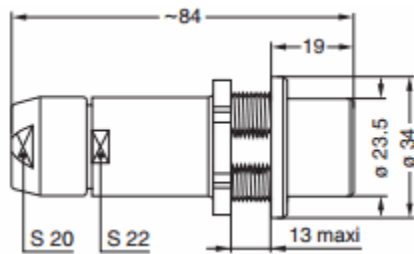

寸法

	A	B	E	M	L	S1	S2	e
mm.	23.5	34	13	19	84	22	20	M25x1.0
になっています。	0.93	1.34	0.51	0.75	3.31	0.87	0.79	

https://www.lemo.com/int_jp/psz-t7-675-ctl06s.html

LEMO products and services are provided "as is". LEMO makes no warranties or representations with regard to LEMO product & services or use of them, express, implied or statutory, including for accuracy, completeness, or security. The user is fully responsible for his products and applications using LEMO components.