



Summary

[Request a quote](#)

[Catalog](#)

Triax	1
Socket / Receptacle	Socket / Receptacle - Fixed Panel Front Mounted
Locking system	Push-pull
Jacket cable outside diameter [mm]	2.50 - 3.20 mm
Size	2S
Matching parts	FFA.2S.675.CLAC32
Series	S - Indoor Stepped Insert

Technical details

Electrical Configuration

Triax	1
Contact Termination Triax	Solder
Insert configuration value	2S.675 - 1 Triax (75 Ohm)
Insulator	L: PEEK (UL 94 / V-0/1.5)
Rated current	6 Amps
Impedance	75 Ohm
VSWR	1.02 + 0.07 * f/GHz
Vtest	1200 V (AC), 1700 V (DC)
Contact Type	Solder
Cable type	Cable type: A Belden 8215,8232A,HF-2426,Triax 8 Nokia,375 029 LEDE, RGT 179 S

https://www.lemo.com/int_en/solutions/originals/s-indoor-stepped-insert/psa-2s-675-cllc32.html

LEMO products and services are provided "as is". LEMO makes no warranties or representations with regard to LEMO product & services or use of them, express, implied or statutory, including for accuracy, completeness, or security. The user is fully responsible for his products and applications using LEMO components.

Form & Material

Shell style / Model id	PSA - Fixed receptacle, nut fixing, cable collet
Socket / Receptacle	Fixed Panel Front Mounted
Housing material	Brass (chrome plated [SAE AMS 2460]) shell and collet nut, nickel plated [SAE AMS QQ N 290] brass latch sleeve and mid pieces
Locking system	Push-pull
Keying	Circular, female
Weight	32.32 g

Environment

Technical domain	Audio Video, Energy and Industrial, Semiconductor, Test and Measurement
Environmental protection (IP rating)	IP50
Minimal temperature	-55°C / +250°C
Climatical Category	50/175/21
Humidity (max)	<=95% [at 60 deg C /140 F]
Shielding (min)	75 dB (10 MHz)
Shielding (min)	40 dB (1 GHz)
Shock Resistance	100 g [6 ms]
Vibration	15 g [10 Hz - 2000 Hz]
Salt Spray Corrosion	>1000 hr

Cable fixation

Cable termination protection	Standard back nut (no additional protection)
Fixation type	Cable collet
Jacket cable outside diameter [mm]	2.50 - 3.20 mm

Drawings

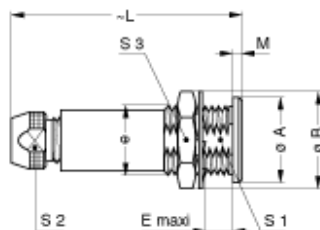

https://www.lemo.com/int_en/solutions/originals/s-indoor-stepped-insert/psa-2s-675-cllc32.html

LEMO products and services are provided "as is". LEMO makes no warranties or representations with regard to LEMO product & services or use of them, express, implied or statutory, including for accuracy, completeness, or security. The user is fully responsible for his products and applications using LEMO components.

Dimensions

	A	B	e	E	L	M	S1	S2	S3	C
mm.	18	19.5	M15x1.0	8.5	50	1.8	13.5	11	17	8.5
in.	0.71	0.77		0.33	1.97	0.07	0.53	0.43	0.67	0.33

https://www.lemo.com/int_en/solutions/originals/s-indoor-stepped-insert/psa-2s-675-cllc32.html

LEMO products and services are provided "as is". LEMO makes no warranties or representations with regard to LEMO product & services or use of them, express, implied or statutory, including for accuracy, completeness, or security. The user is fully responsible for his products and applications using LEMO components.