



Summary

[Request a quote](#)

[Catalog](#)

| | |
|---------------------|--|
| Low Voltage | 10 |
| Gender | Standard |
| Socket / Receptacle | Socket / Receptacle - Fixed Panel Rear Mounted |
| Locking system | Push-pull |
| Size | 1P |
| Matching parts | PAG.M1.0GL.AC39Z |
| Series | REDEL P - Push-Pull |

Technical details

https://www.lemo.com/int_en/solutions/redel/redel-p-push-pull/pkg-m1-0gl-vz.html

LEMO products and services are provided "as is". LEMO makes no warranties or representations with regard to LEMO product & services or use of them, express, implied or statutory, including for accuracy, completeness, or security. The user is fully responsible for his products and applications using LEMO components.

Electrical Configuration

| | |
|---------------------------------------|---------------------------|
| Contact Termination Low voltage | PCB - Elbow |
| R (max) | 8.5 mOhm |
| Insert configuration value | 1P.M10 - 10 Low Voltage |
| Insulator | L: PEEK (UL 94 / V-0/1.5) |
| Rated current | 3 Amps |
| Test voltage (kV rms) Contact-contact | 0.85 |
| Contact Type | Print (elbow) |
| Air clearance | 0.45 mm |
| Creepage distance | 0.45 mm |
| Contact Dia. | 0.5 mm (0.0201in) |
| Low Voltage | 10 |
| Gender | Standard |

Form & Material

| | |
|------------------------|---|
| Shell style / Model id | PK - Fixed receptacle with two nuts (back panel mounting), 90° print contacts |
| Socket / Receptacle | Fixed Panel Rear Mounted |
| Housing material | PSU (Polysulfone), gray |
| Locking system | Push-pull |
| Keying | 1 key (alpha=0, Plug: male contact, Receptacle: female contact) |
| Variant | without front nut |
| Weight | 5.9 g |

Environment

| | |
|--------------------------------------|---|
| Technical domain | Energy and Industrial, Medical, Test and Measurement, Transportation, Aerospace and UAV |
| Environmental protection (IP rating) | IP50 |
| Minimal temperature | -50°C / +150°C |
| F ret (max) | 150 N |
| F ret (min) | 50 N |
| Steam sterilization | > 100 times (with potting on rear connection) |

https://www.lemo.com/int_en/solutions/redel/redel-p-push-pull/pkg-m1-0gl-vz.html

LEMO products and services are provided "as is". LEMO makes no warranties or representations with regard to LEMO product & services or use of them, express, implied or statutory, including for accuracy, completeness, or security. The user is fully responsible for his products and applications using LEMO components.

Cable fixation

Cable termination protection

For cable bend relief

Fixation type

Cable collet

Drawings

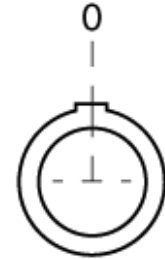
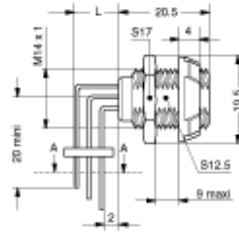

Dimensions

| | A | L | N |
|-----|------|----------|------|
| mm. | 19.5 | 5.2-12.9 | 20.5 |
| in. | 0.77 | | 0.81 |

https://www.lemo.com/int_en/solutions/redel/redel-p-push-pull/pkg-m1-0gl-vz.html

LEMO products and services are provided "as is". LEMO makes no warranties or representations with regard to LEMO product & services or use of them, express, implied or statutory, including for accuracy, completeness, or security. The user is fully responsible for his products and applications using LEMO components.