



Summary

[Request a quote](#)

[Catalog](#)

Coax	1
Plug	Plug - Straight
Locking system	Push-pull
Jacket cable outside diameter [mm]	2.80 - 3.10 mm
Matching parts	ERA.00.250.CTL
Series	00 - NIM-CAMAC

Technical details

https://www.lemo.com/int_en/solutions/specialties/00-nim-camac/ffa-00-250-ctac31z.html

LEMO products and services are provided "as is". LEMO makes no warranties or representations with regard to LEMO product & services or use of them, express, implied or statutory, including for accuracy, completeness, or security. The user is fully responsible for his products and applications using LEMO components.

Electrical Configuration

Coax	1
Contact Termination Coax	Solder
R (max)	6.1 mOhm
Insert configuration value	0.25 - 1 Coax (50 Ohm)
Insulator	T: PTFE
Rated current	4 Amps
Impedance	50 Ohm
VSWR	$1.09 + 0.11 * f/\text{GHz}$
Vtest	2100 V (AC), 3000 V (DC)
Contact Type	Coaxial 50 Ohm (Solder)
Test voltage	2.1 kV (rms)
Cable type	Cable type: A RG 174 A/U S
Bucket Dia.	0.6 mm (0.024in)
Contact Dia.	0.7 mm (0.028in)

Form & Material

Shell style / Model id	FFA - Straight plug with cable collet and nut for fitting a bend relief
Plug	Straight
Housing material	Brass (chrome plated [SAE AMS 2460]) shell and collet nut, nickel plated [SAE AMS QQ N 290] brass latch sleeve and mid pieces
Locking system	Push-pull
Keying	Circular, male
Variant	Nut for fitting a bend relief
Weight	3.7 g

Environment

Environmental protection (IP rating)	IP50
F ret (min)	100 N
Salt Spray Corrosion	>1000 hr

https://www.lemo.com/int_en/solutions/specialties/00-nim-camac/ffa-00-250-ctac31z.html

LEMO products and services are provided "as is". LEMO makes no warranties or representations with regard to LEMO product & services or use of them, express, implied or statutory, including for accuracy, completeness, or security. The user is fully responsible for his products and applications using LEMO components.

Cable fixation

Cable termination protection	For cable bend relief
Fixation type	Cable collet
Jacket cable outside diameter [mm]	2.80 - 3.10 mm

Drawings

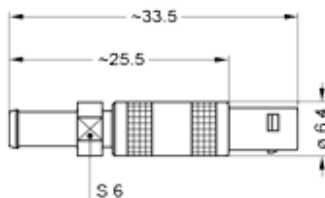

Dimensions

	A	M	L
mm.	6.4	25.5	33.5
in.	0.25	1	1.32

Recommended By Lemo

Accessories

Tools

Spanner wrench

[DCD.00.ZZZ.PA060](#)

Cables

Cable PartNumber	Material	Colour	Cable image
17420	PVC	Black	
31600	PTFE	Brown	
CCX.50.RG1.74AU28N	PVC	Black	
CCX.50.RG1.74AU28N	PVC	Black	
CCX.50.RG3.16U28M	PTFE	Brown	

https://www.lemo.com/int_en/solutions/specialties/00-nim-camac/ffa-00-250-ctac31z.html

LEMO products and services are provided "as is". LEMO makes no warranties or representations with regard to LEMO product & services or use of them, express, implied or statutory, including for accuracy, completeness, or security. The user is fully responsible for his products and applications using LEMO components.