

## Summary

[Request a quote](#)

[Catalog](#)

Triax	1
Plug	Plug - Fixed
Locking system	Push-pull
Size	0S
Matching parts	<a href="#">PCA.0S.650.CLLC32</a>
Series	S - Indoor Stepped Insert

## Technical details

### Electrical Configuration

Triax	1
Contact Termination Triax	Solder
Insert configuration value	0S.650 - 1 Triax (50 Ohm)
Insulator	T: PTFE
Rated current	6 Amps
Impedance	50 Ohm
VSWR	1.03 + 0.34 * f/GHz
Vtest	1200 V (AC), 1700 V (DC)
Contact Type	Triaxial 50 Ohm (Solder)
Cable type	Cable type: A RGT 178, RGT 174 S
Bucket Dia.	0.8
Contact Dia.	0.9 mm (0.035" in)

[https://www.lemo.com/int\\_en/solutions/originals/s-indoor-stepped-insert/faa-0s-650-ctl.html](https://www.lemo.com/int_en/solutions/originals/s-indoor-stepped-insert/faa-0s-650-ctl.html)

LEMO products and services are provided "as is". LEMO makes no warranties or representations with regard to LEMO product & services or use of them, express, implied or statutory, including for accuracy, completeness, or security. The user is fully responsible for his products and applications using LEMO components.

## Form & Material

Shell style / Model id	FAA - Fixed plug, non-latching, nut fixing
Plug	Fixed
Housing material	Brass (chrome plated [SAE AMS 2460]) shell and collet nut, nickel plated [SAE AMS QQ N 290] brass latch sleeve and mid pieces
Locking system	Push-pull
Keying	Circular, female
Weight	5.06 g

## Environment

Technical domain	Audio Video, Energy and Industrial, Semiconductor, Test and Measurement
Environmental protection (IP rating)	IP50
Minimal temperature	-55°C / +250°C
Climatical Category	50/175/21
Humidity (max)	<=95% [at 60 deg C /140 F]
Shielding (min)	75 dB (10 MHz)
Shielding (min)	40 dB (1 GHz)
Shock Resistance	100 g [ 6 ms]
Vibration	15 g [10 Hz - 2000 Hz]
Salt Spray Corrosion	>1000 hr

## Drawings

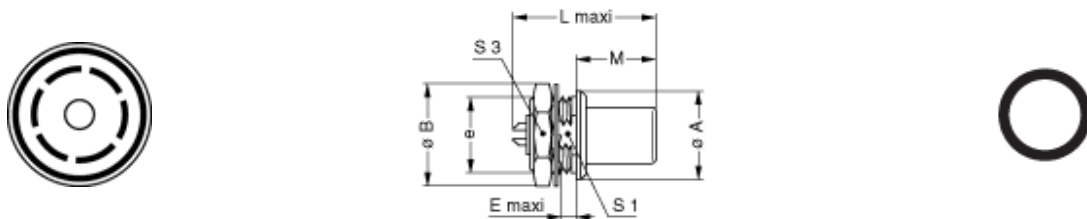

## Dimensions

	<b>M</b>	<b>A</b>	<b>B</b>	<b>e</b>	<b>E</b>	<b>L</b>	<b>S1</b>	<b>S3</b>
mm.	11.2	10	12.5	M9x0.6	2	18.5	8.2	11
in.	0.44	0.39	0.49		0.08	0.73	0.32	0.43

[https://www.lemo.com/int\\_en/solutions/originals/s-indoor-stepped-insert/faa-0s-650-ctl.html](https://www.lemo.com/int_en/solutions/originals/s-indoor-stepped-insert/faa-0s-650-ctl.html)

LEMO products and services are provided "as is". LEMO makes no warranties or representations with regard to LEMO product & services or use of them, express, implied or statutory, including for accuracy, completeness, or security. The user is fully responsible for his products and applications using LEMO components.